

ALP-60

SURFACE MOUNT LED PROFILE

Project _____
Location _____
Quote/ Ref # _____

The **ALP-60** is an Architectural-grade LED extrusion designed for surface mount applications and can fit linear LED strips up to 11mm (0.43") wide. Made from high quality aluminum, these extrusions provide superior thermal management for higher wattage LED strips and prolong the lifespan of your lighting system. This surface mount profile is manufactured with a patented frosted diffuser for maximum lumen output and wider beam distribution. These aluminum profiles are an elegant design solution for any space.



SPECIFICATIONS

| | |
|--------------------|--------------------------------------|
| TYPE | Surface Mount |
| LED STRIP | Fits LED strips up to 11mm (0.43 in) |
| LENGTHS | 49.25" / 84" / 98.5" |
| FINISH | White/ Black/ Silver |
| LENS OPTIONS | Frosted, Black |
| CHANNEL | ALP60 |
| LENS | ALP60-LN |
| END CAP | ALP60-EC |
| MOUNTING CLIPS | ALP60-CL |
| ADJUSTABLE BRACKET | ALP60-BKT-ADJ (Tall) |
| ADJUSTABLE BRACKET | ALP60-ASB |
| WEIGHT | 5.33 lbs |

FEATURES

- Customizable
- Compatible with LED strips up to 11mm (0.43 in) wide
- Durable, anodized aluminum
- Protects LED systems from dust and other elements
- Slim, low profile design
- Dissipates heat from LED, prolonging its lifetime

*LED strips sold separately



| MODEL | LENGTH | LENS | FINISH |
|-------|------------------------|----------------------|--------------------------------------|
| ALP60 | 49 49.25 In. | FR Frosted | WH White |
| | 84 84 In. | BL Black | BK Black |
| | 98 98.5 In. | | SI Silver |
| | | | CU Custom (powder-coat) |

* Custom color finishes require powder coating. Allow 7 days lead time.

ALP-60

SURFACE MOUNT LED PROFILE

DIMENSIONS

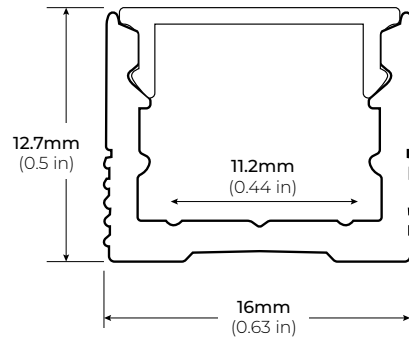

ACCESSORIES

ALP60-EC END CAP

*2 end caps included with every profile

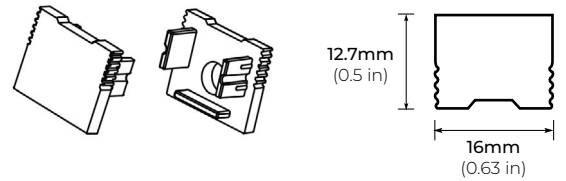

ALP60-CL METAL MOUNTING CLIPS

*2 mounting clips included with every profile

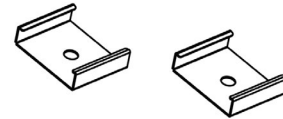

ALP60-BKT-ADJ ADJUSTABLE BRACKET

*Sold separately

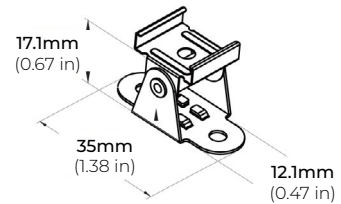

ALP60-ASB ADJUSTABLE BRACKET

*Sold separately

