

# LSM-55MX

## 5.5W INDOOR COLOR-TUNING FLEXIBLE LED STRIP

Project \_\_\_\_\_  
Location \_\_\_\_\_  
Quote/ Ref # \_\_\_\_\_

**LSM-55MX** is a hybrid version of the LM-55 series. It features combined Color Temperatures in one LED strip ranging from warm 2200K to cool 5000K. It is capable of delivering 500+ lumens, dimmable and attaches to most surfaces. These strips are great for many common indoor applications.



### SPECIFICATIONS

INPUT VOLTAGE	24V DC
POWER CONSUMPTION	5.5W/Ft.
NO. OF LEDS	81 LEDs per Ft.
LUMEN OUTPUT	500+ Lm/Ft.
CRI	95+
DIMMING	0-10V
MAXIMUM RUN LENGTH	12 Ft.
CUTTABLE	Every 2 in (50.8mm)
BINNING	1.5 Step Macadam Elipse
OPERATING TEMPERATURE	-40°F (-40°C) ~ 140°F (60°C)
BEAM ANGLE	120°
IP RATING	IP45 dry location (Indoor)
CERTIFICATIONS	UL Listed, TITLE 24 JA8, RoHS
LUMEN MAINTENANCE	50,000 Hrs.

\*Approved for closet / storage space installation per NEC 410.16(A)(3) and 410.16(C)(5)



MODEL	COLOR TEMP A	COLOR TEMP B	LENGTH	VOLTAGE	PROFILE
LSM55MX	<b>18K</b> 1800K	<b>27K</b> 2700K	<b>16</b> 16 Ft.	<b>24</b> 24V DC	<i>See Page 2 for compatible profiles.</i>
	<b>22K</b> 2200K	<b>30K</b> 3000K	<b>100</b> 100 Ft.		
	<b>25K</b> 2500K	<b>35K</b> 3500K	<b>1XX</b> per Ft.		
	<b>27K</b> 2700K	<b>42K</b> 4200K			
	<b>30K</b> 3000K	<b>50K</b> 5000K			
	<b>35K</b> 3500K	<b>60K</b> 6000K			
	<b>42K</b> 4200K				
	<b>50K</b> 5000K				
<b>60K</b> 6000K			*1 = Custom length per FT. (Cuttable every 2")		* Custom color finishes require powder coating. Allow 7 days leads time.

# LSM-55MX

## 5.5W INDOOR COLOR-TUNING FLEXIBLE LED STRIP

### DIMENSIONS

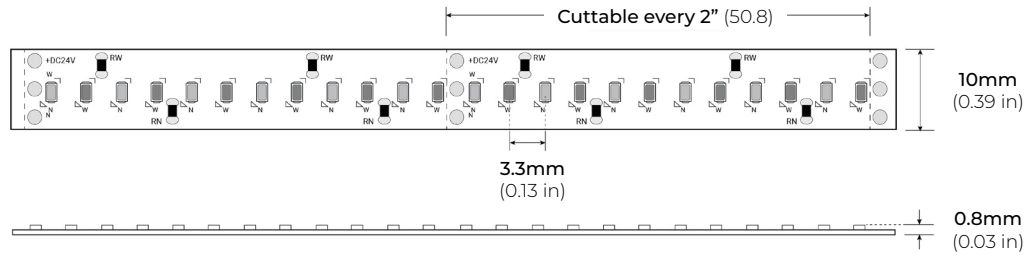

### COMPATIBLE ALUMINUM PROFILES

#### SURFACE PROFILES

##### ALU-SF

LENGTHS 39" | 78" | 84" | 98"  
LENS Clear, Frosted  
FINISH Black | Silver

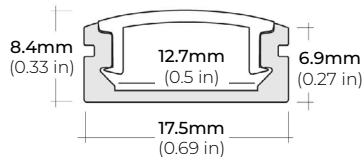

##### ALU-CN (CORNER)

LENGTHS 39" | 78" | 84" | 96"  
LENS Clear, Frosted  
FINISH Black | Silver

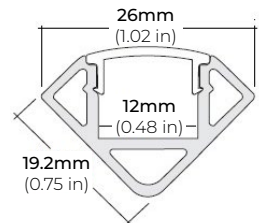

##### ALU-DS100

LENGTHS 39" | 78" | 84"  
LENS Clear, Frosted  
FINISH Silver

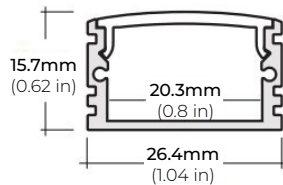

##### ALP-20

LENGTHS 49" | 84" | 98"  
LENS Frosted  
FINISH White | Black | Silver

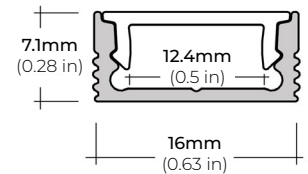

##### ALP-35

LENGTHS 49" | 98"  
LENS Frosted  
FINISH White | Black | Silver

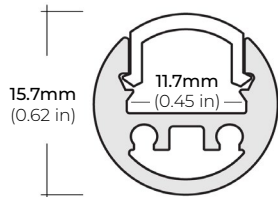

##### ALP-50C-V2 (CORNER)

LENGTHS 48" | 84" | 98"  
LENS Frosted  
FINISH White | Black | Silver

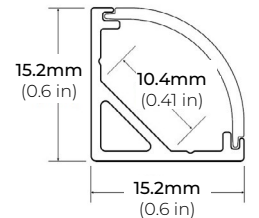

##### ALP-60

LENGTHS 49" | 84" | 98"  
LENS Frosted  
FINISH White | Black | Silver

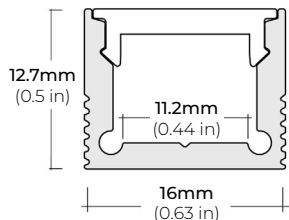

##### ALP-65

LENGTHS 48" | 96"  
LENS Clear  
FINISH Silver

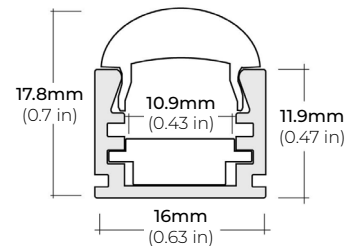

#### RECESSED PROFILES

##### ALP-20R

LENGTHS 49" | 98"  
LENS Frosted  
FINISH White | Black | Silver

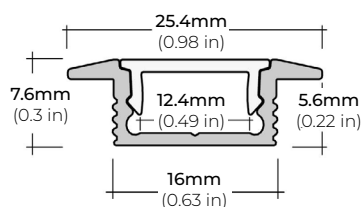

##### ALP-60R

LENGTHS 49" | 84" | 98"  
LENS Frosted  
FINISH White | Black | Silver

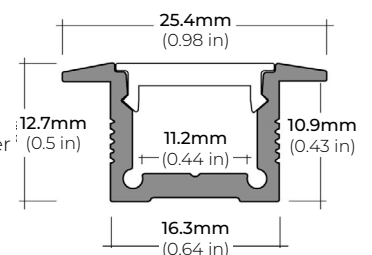

\* For more compatible profiles, visit [corelightingusa.com](http://corelightingusa.com)

# LSM-55MX

## 5.5W INDOOR COLOR-TUNING FLEXIBLE LED STRIP

### COMPATIBLE 0-10V DIMMING MODULE

0-10V Dimming modules require a non-dimming driver.  
Please refer to page 5 for compatible options.

**PSDE-TW2-010-CT**  
0-10V CONTROL

INPUT VOLTAGE	8-48V DC
INPUT CURRENT	5.1A MAX (per channel)
INPUT CONTROL	2
OUTPUT CURRENT	5A
MAX OUTPUT POWER	240W
DIMENSIONS	LxWxH (3.86" X 1.73" X 0.57")



### BASIC CONTROLLERS

All controllers require a paired receiver and a Non-Dimming Driver.  
Please refer to page 5 for compatible options.

**RGB-CT820**  
BLUETOOTH TOUCH PANEL WALL CONTROLLER

INPUT VOLTAGE	12-24V DC
ZONES	4
CONTROL MODE	Color Tuning
WIRELESS PROTOCOL	Bluetooth 5.0 SIG Mesh
WORKING TEMP	-20°C ~ 55°C
DIMENSIONS	LxWxH (4.7"x3"x1.2")

\* Paired with RGB-CT800-RC (Sold Separately)



**RGB-CT800-RC**  
BLUETOOTH CONSTANT VOLTAGE LED RECEIVER

INPUT VOLTAGE	12V   24V
OUTPUT CURRENT	4Ax5CH / 5Ax4CH (20A Max)
POWER CAPACITY	240W (12V)   480W (24V)
PROGRAMMABILITY	iOS and Android
WORKING TEMP	-20°C ~ 55°C
DIMENSIONS	LxWxH (6.9 x 1.7 x 1.2")

\* Paired with RGB-CT820 (Sold Separately)



# LSM-55MX

## 5.5W INDOOR COLOR-TUNING FLEXIBLE LED STRIP

### DMX CONTROLLERS

All DMX Controllers require a DMX Decoder and Non-Dimming Driver.  
Please refer to page 5 for compatible options.

#### RGB-SCW4 WiFi DMX WALL CONTROLLER

INPUT VOLTAGE	5 - 10V DC, 06A
OUTPUT SIGNAL	DMX512 (x2)
PROGRAMMABILITY	PC/ MAC
COLOR OPTIONS	Black/ White
CONNECTIONS	USB/ 8dry contact ports/ Open drain output (for relay)
MEMORY	Built-In Flash
WORKING TEMP	-10°C ~ 45°C
DIMENSIONS	LxWxH (5.75"x4.17"x0.43")

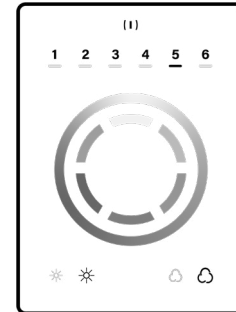

#### RGB-SDE3 WiFi DMX WALL CONTROLLER

INPUT VOLTAGE	6V DC, 0.6A
OUTPUT SIGNAL	DMX512 (x2)
PROGRAMMABILITY	PC/ MAC/ Tablet/ Smartphone
COLOR OPTIONS	Black/ White
CONNECTIONS	USB/ Ethernet/ RS232/ CLock/ 8dry contact ports/ 5V output relay
MEMORY	MicroSD Card
WORKING TEMP	-20°C ~ 40°C
DIMENSIONS	LxWxH (5.75"x4.17"x0.43")

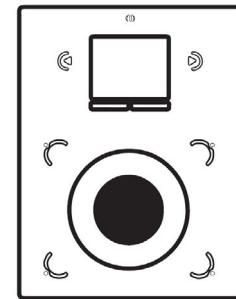

### DMX DECODERS

All DMX Decoders require a DMX Controller and Non-Dimming Driver.  
Please refer to page 5 for compatible options.

#### RGB-DMX-4C-RJ45 4-CHANNEL DMX DECODER

INPUT VOLTAGE	12V-24V DC
OUTPUT CURRENT	5A X 4CH
OUTPUT WATTAGE	60W(12V), 120W(24V)
OUTPUT CHANNELS	4
DIMENSIONS	LxWxH (7"x1.77"x0.75")

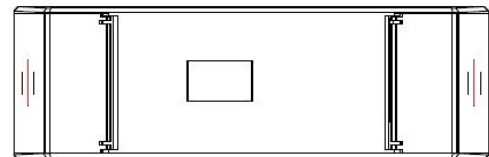

#### RGB-DMX-5C-XLR 5-CHANNEL DMX DECODER

INPUT VOLTAGE	12V-24V DC
OUTPUT CURRENT	8A X 5CH
OUTPUT WATTAGE	5 x (96W ~ 192W)
OUTPUT CHANNELS	5
DIMENSIONS	LxWxH (6.45"x2.87"x1.5")

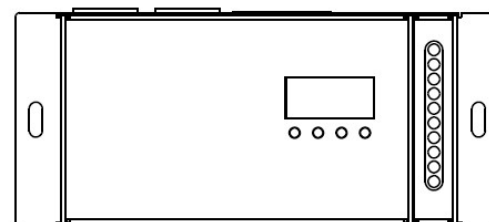

# LSM-55MX

## 5.5W INDOOR COLOR-TUNING FLEXIBLE LED STRIP

### COMPATIBLE NON-DIMMING DRIVERS

#### PSHK SERIES

NON-DIMMING CONSTANT VOLTAGE WITH JUNCTION BOX

PSHK-30W-24V	CLASS 2	6.5" X 3.6" X 1.02"
PSHK-60W-24V	CLASS 2	7.4" X 3.62" X 1.02"
PSHK-96W-24V	CLASS 2	8.66" X 3.66" X 1.61"
PSHK-150W-24V		10.24" X 4.06" X 1.81"
PSHK-200W-24V		10.24" X 4.06" X 1.81"
PSHK-288W-24V	CLASS 2	11.85" X 4.25" X 1.82"
PSHK-300W-24V		10.24" X 4.25" X 1.81"

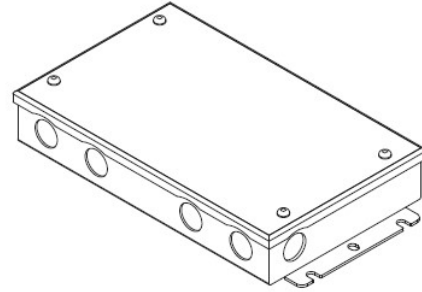

### COMPATIBLE DALI DIMMING DRIVERS

#### PSDE-96W-24V-UNV-DALI-2-DT8

DALI-2 DIMMING DRIVER

CLASS 2	Yes
INPUT VOLTAGE	100-277V AC
INPUT CURRENT	1.25A MAX
OUTPUT CURRENT	4A
MAX OUTPUT POWER	96W
DIMENSIONS	LxWxH (9.52" x 4.88" x 1.6")

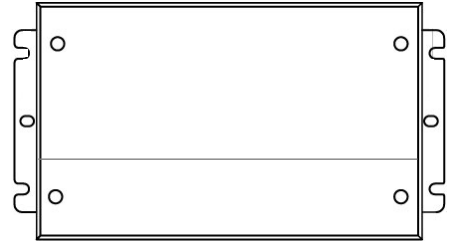

\* Non-dimming driver not required.