

LSM-25

2.2W INDOOR FLEXIBLE LED STRIP

Project _____

Location _____

Quote/ Ref # _____

LSM-25 is a dimmable flexible LED strip capable of delivering 185 Lumens of light output per Ft. Rated to last 50,000 hours making it an excellent replacement for halogen lighting. Its innovative low profile design makes it suitable for cove lighting, under cabinets, architectural and aesthetic enhancements. Its high lumen output, excellent color rendering, and color temperature options make perfect for most commercial or residential lighting applications.



SPECIFICATIONS

| | |
|-----------------------|---|
| INPUT VOLTAGE | 24V DC |
| POWER CONSUMPTION | 2.2W/Ft. |
| NO. OF LEDS | 18 LEDs per Ft. |
| LUMEN OUTPUT | 185 Lm/Ft. (3000K) |
| CRI | 95+ |
| COLOR TEMPERATURE | 24K / 27K / 30K / 35K / 40K / 50K / 60K |
| DIMMING | MLV, ELV, 0-10 and TRIAC |
| MAXIMUM RUN LENGTH | 30 Ft. |
| CUTTABLE | Every 3.92 in (99.64mm) |
| BINNING | 1.5 Step Macadam Elipse |
| OPERATING TEMPERATURE | -40°F (-40°C) ~ +140°F (+60°C) |
| BEAM ANGLE | 120° |
| IP RATING | Dry location (Indoor) |
| CERTIFICATIONS | UL Listed, TITLE 24 JAB |
| LUMEN MAINTENANCE | 50,000 Hrs. |

LUMENS

| CCT | LM/ FT | CRI | R9 | R13 |
|-------|--------|-----|----|-----|
| 2400K | 174 | 92 | 67 | 95 |
| 2700K | 185 | 93 | 80 | 96 |
| 3000K | 185 | 90 | 71 | 93 |
| 3500K | 195 | 90 | 72 | 94 |
| 4000K | 201 | 91 | 76 | 94 |
| 5000K | 206 | 93 | 84 | 97 |
| 6000K | 209 | 90 | 73 | 94 |

*Approved for closet / storage space installation per NEC 410.16(A)(3) and 410.16(C)(5)



| MODEL | COLOR TEMP | LENGTH | VOLTAGE | PROFILE |
|-------|---------------------|--|----------------------|--|
| LSM25 | 24K 2400K | 16 16 Ft. | 24V 24V DC | <i>See Page 3 for compatible profiles.</i> |
| | 27K 2700K | 100 100 Ft. | | |
| | 30K 3000K | 1XX per Ft. | | |
| | 35K 3500K | | | |
| | 40K 4000K | | | |
| | 50K 5000K | | | |
| | 60K 6000K | *1 = Custom length per FT. (Cuttable every 3.92") | | * Custom color finishes require powder coating. Allow 7 days leads time. |

LSM-25

2.2W INDOOR FLEXIBLE LED STRIP

DIMENSIONS

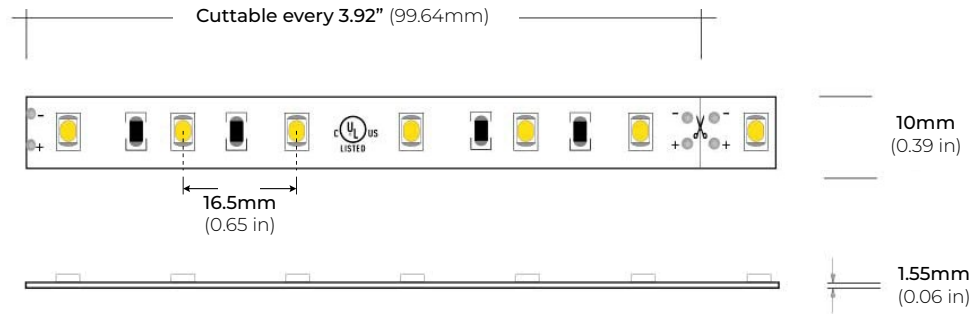

COMPATIBLE CONNECTORS

For more information about connector-profile compatibility, visit corelightingusa.com/tape-light-accessories.

HP PRO CONNECTORS

QUICK CONNECT SNAP-ON
(0.96" X 0.57" X 0.3")

- LSA-HW8-HP 8" HARDWIRE CONNECTOR
- LSA-HW24-HP 24" HARDWIRE CONNECTOR
- LSA-HW60-HP 60" HARDWIRE CONNECTOR
- LSA-HW120-HP 120" HARDWIRE CONNECTOR

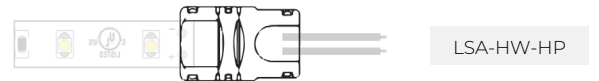

- LSA-EX3-HP 3" LINK
- LSA-EX8-HP 8" LINK
- LSA-EX24-HP 24" LINK

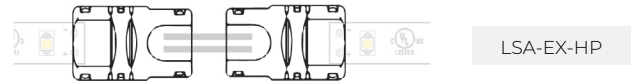

- LSA-MC-HP MINI COUPLING



- LSA-DC24-HP 24" DC CONNECTOR

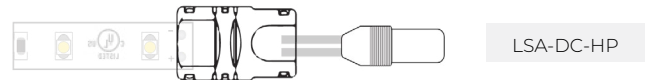

LSA-TB

SOLDERLESS LED STRIP/ WIRE BLOCK CONNECTOR

- LSA-TB-HWC-2A 2 AMP MAX HARDWIRE CONNECTOR
53W MAX (24V)
(0.53" X 0.45" X 0.26")



- LSA-TB-HWC-4A 4 AMP MAX HARDWIRE CONNECTOR
53W MAX (24V)
(0.45" X 0.48" X 0.31")



- LSA-TB-MC-4A 4 AMP MAX STRIP TO STRIP CONNECTOR
53W MAX (24V)
(0.45" X 0.48" X 0.31")



LSM-25

2.2W INDOOR FLEXIBLE LED STRIP

COMPATIBLE ALUMINUM PROFILES

SURFACE PROFILES

ALU-SF

LENGTHS 39" | 78" | 84" | 98"
LENS Clear, Frosted
FINISH Black | Silver

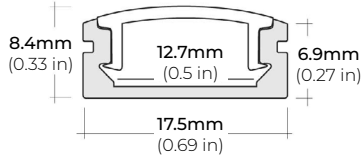

ALU-CN (CORNER)

LENGTHS 39" | 78" | 84" | 96"
LENS Clear, Frosted
FINISH Black | Silver

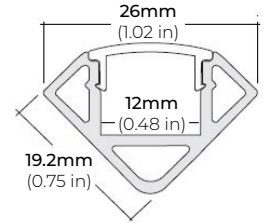

ALU-DS100

LENGTHS 39" | 78" | 84"
LENS Clear, Frosted
FINISH Silver

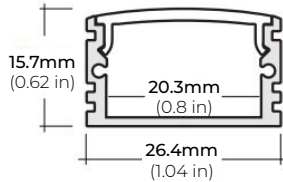

ALP-20

LENGTHS 49" | 84" | 98"
LENS Frosted
FINISH White | Black | Silver

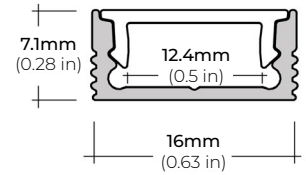

ALP-35

LENGTHS 49" | 98"
LENS Frosted
FINISH White | Black | Silver

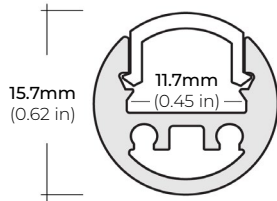

ALP-50C-V2 (CORNER)

LENGTHS 48" | 84" | 98"
LENS Frosted
FINISH White | Black | Silver

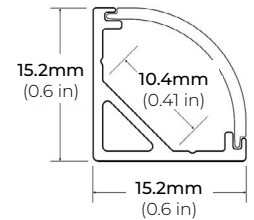

ALP-60

LENGTHS 49" | 84" | 98"
LENS Frosted
FINISH White | Black | Silver

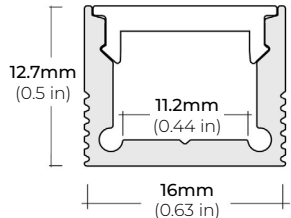

ALP-65

LENGTHS 48" | 96"
LENS Clear
FINISH Silver

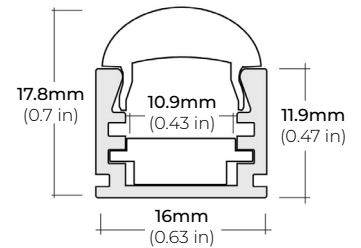

ALP-70

LENGTHS 49" | 84" | 98"
LENS Frosted
FINISH White | Black | Silver

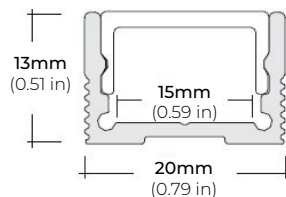

ALP-80

LENGTHS 49" | 98"
LENS Frosted
FINISH Silver

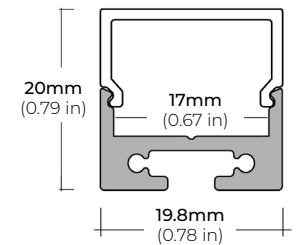

* For more compatible profiles, visit corelightingusa.com

RECESSED PROFILES

ALP-20R

LENGTHS 49" | 98"
LENS Frosted
FINISH White | Black | Silver

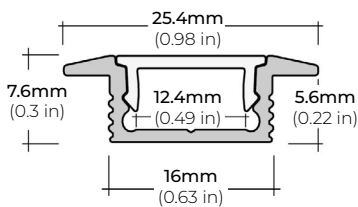

ALP-60R

LENGTHS 49" | 84" | 98"
LENS Frosted
FINISH White | Black | Silver

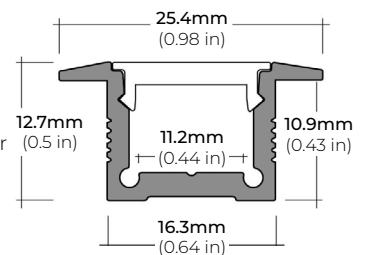

* For more compatible profiles, visit corelightingusa.com

LSM-25

2.2W INDOOR FLEXIBLE LED STRIP

COMPATIBLE TRANSFORMERS

PSDL SERIES TRIAC DIMMABLE

| | | |
|---------------|---------|------------------------|
| PSDL-30W-24V | CLASS 2 | 6.5" X 3.63" X 1.03" |
| PSDL-60W-24V | CLASS 2 | 7.4" X 3.63" X 1.03" |
| PSDL-96W-24V | CLASS 2 | 8.67" X 3.67 X 1.62" |
| PSDL-150W-24V | | 8.67" X 3.67" X 1.62" |
| PSDL-192W-24V | CLASS 2 | 10.25" X 4.06" X 1.82" |
| PSDL-200W-24V | | 10.25" X 4.06" X 1.82" |
| PSDL-288W-24V | CLASS 2 | 10.25" X 4.06" X 1.82" |
| PSDL-300W-24V | | 10.25" X 4.06" X 1.82" |

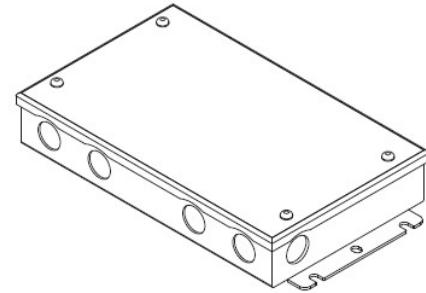

PSDH SERIES HIGH PERFORMANCE MAGNETIC LOW VOLTAGE (MLV)

| | | |
|---------------|---------|------------------------|
| PSDH-48W-24V | CLASS 2 | 11.25" X 3.37" X 3.25" |
| PSDH-96W-24V | CLASS 2 | 11.25" X 3.37" X 3.25" |
| PSDH-288W-24V | CLASS 2 | 14.25" X 8.43" X 4.43" |

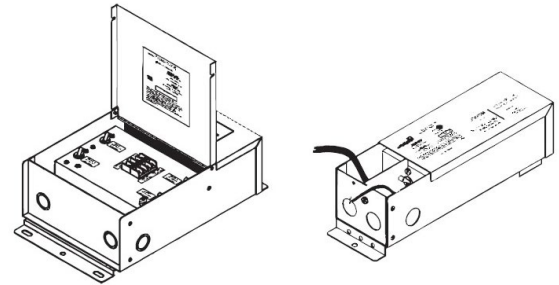

PSRX SERIES 4-IN-1 DIMMING DRIVER

| | | |
|---------------|---------|------------------------|
| PSRX-30W-24V | CLASS 2 | 6.5" X 3.72" X 1.57" |
| PSRX-60W-24V | CLASS 2 | 7.4" X 3.72" X 1.57" |
| PSRX-96W-24V | CLASS 2 | 8.66" X 3.72" X 1.57" |
| PSRX-150W-24V | | 10.24" X 4.13" X 1.77" |
| PSRX-192W-24V | CLASS 2 | 11" X 4" X 1.82" |
| PSRX-200W-24V | | 10.24" X 4.13" X 1.77" |
| PSRX-288W-24V | CLASS 2 | 11.85" X 4.25" X 1.82" |
| PSRX-300W-24V | | 10.94" X 4.33" X 1.77" |

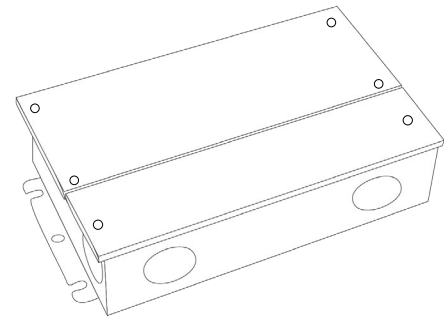

PSVT SERIES 0-10V DIMMING DRIVER

| | | |
|---------------|---------|------------------------|
| PSVT-60W-24V | CLASS 2 | 7.4" X 3.72" X 1.57" |
| PSVT-96W-24V | CLASS 2 | 8.66" X 3.72" X 1.57" |
| PSVT-200W-24V | | 10.24" X 4.13" X 1.77" |
| PSVT-288W-24V | CLASS 2 | 11.85" X 4.25" X 1.81" |
| PSVT-300W-24V | | 10.94" X 4.33" X 1.77" |

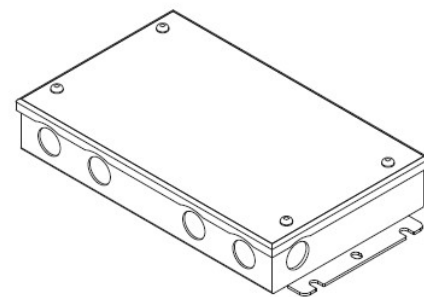

LSM-25

2.2W INDOOR FLEXIBLE LED STRIP

COMPATIBLE TRANSFORMERS

PSDE SERIES
0-10V DIMMING W/ JUNCTION BOX

| | | |
|---------------------|---------|----------------------|
| PSDE-60W-24V-010-JB | CLASS 2 | 12.1" X 2.36" X 1.4" |
| PSDE-96W-24V-010-JB | CLASS 2 | 12.1" X 2.36" X 1.4" |

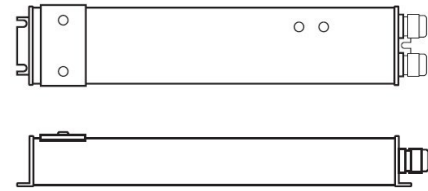

LUTRON 1%
3-WIRE DIMMING

| | | |
|------------------|---------|--------------------|
| L3DA4U1UKL-CV240 | CLASS 2 | 4.89" X 4" X 2.62" |
|------------------|---------|--------------------|

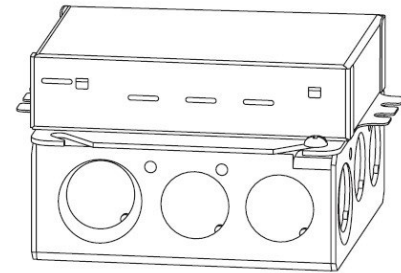

LUTRON 1%

| | | |
|------------------|---------|---------------------|
| PSDE-96W-24V-ECO | CLASS 2 | 10.5" X 3.0" X 2.0" |
|------------------|---------|---------------------|

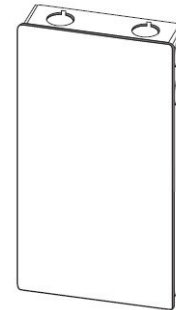

COMPATIBLE NON-DIMMING DRIVERS

PSHK SERIES
NON-DIMMING CONSTANT VOLTAGE WITH JUNCTION BOX

| | | |
|---------------|---------|------------------------|
| PSHK-30W-24V | CLASS 2 | 6.5" X 3.6" X 1.02" |
| PSHK-60W-24V | CLASS 2 | 7.4" X 3.62" X 1.02" |
| PSHK-96W-24V | CLASS 2 | 8.66" X 3.66" X 1.61" |
| PSHK-150W-24V | | 10.24" X 4.06" X 1.81" |
| PSHK-200W-24V | | 10.24" X 4.06" X 1.81" |
| PSHK-288W-24V | CLASS 2 | 11.85" X 4.25" X 1.82" |
| PSHK-300W-24V | | 10.24" X 4.25" X 1.81" |

