

SLINQ

FLEXIBLE 360° ROUND NEON SERIES

Project _____

Location _____

Quote/ Ref # _____

Set your creativity free and unleash the endless possibilities. Different mounting options allow for pendants, suspended mounts, flush mounts, arches and free form designs. The 360° light source gives illumination no matter how the fixture is mounted. Discover what you can create with the **SLINQ** Neon Series.

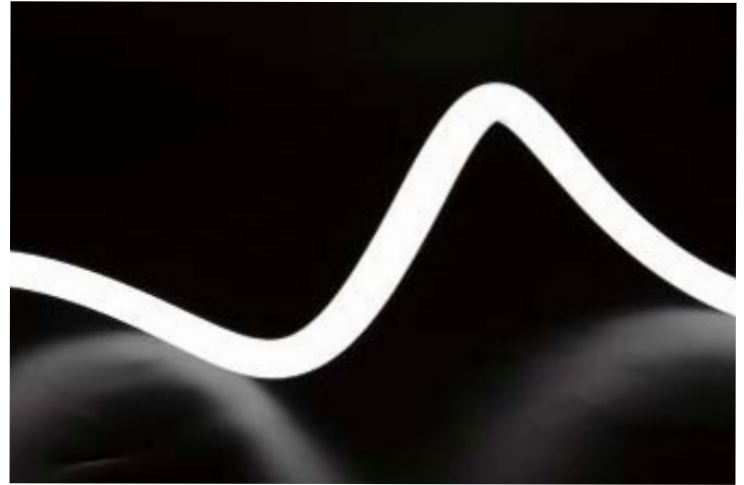

SPECIFICATIONS

POWER CONSUMPTION	4.4W per foot
LUMEN OUTPUT	317 Lm/ Ft. (30K)
CRI	90+
COLOR TEMPERATURE	24K/ 27K/ 30K/ 35K/ 40K/ 50K
MAXIMUM RUN LENGTH	16 Ft. (24V) / 65 Ft. (48V)
OPERATING VOLTAGE	24V / 48V
STORAGE TEMPERATURE	-30°C to 60°C
OPERATING TEMPERATURE	30°C (-22°F) to 55°C (131°F)
BEAM ANGLE	360°
IP RATING	IP65 Outdoor/ Wet Location
LUMEN MAINTENANCE	50,000 Hrs.

FEATURES

- 360° Light Source
- Multiple Mounting Options
- Universal Dimming
- Available in 24V and 48V DC
- IP65 Outdoor Rated
- Factory-Installed Power Feed
- Injection Moulded End-Caps
- Ideal for Decorative, Retail, Artistic Lighting

**This product is factory-cut only. Do not field modify.*



MODEL	COLOR TEMP	LENGTH	VOLTAGE	POWER FEED	MOUNTING OPTIONS
SLQ25-FX	24K 2400K	1PF Per Foot	24V 24 Volts	EF72 72" End Feed	AR Arch
	27K 2700K		48V 48 Volts	SF72 72" Side Feed	SF Surface Pendant
	30K 3000K				SUP Suspended Pendant
	35K 3500K				SCS Suspension Cable Support
	40K 4000K				SJS Suspension Joiner Support
	50K 5000K				TES Telescopic Extension Support
				TJS Telescopic Joiner Support	
		*1 = Custom length per FT. (24V - Every 0.47") (48V - Every 3.28")		*MAX RUN: 24V - 16 Ft. 48V - 65 Ft.	

SLINQ

FLEXIBLE 360° ROUND NEON SERIES

MOUNTING OPTIONS

ARCH (AR)

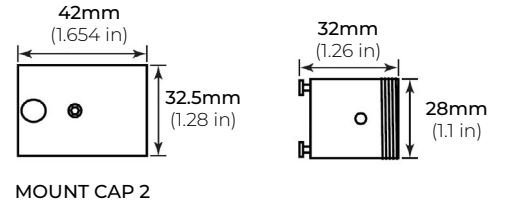
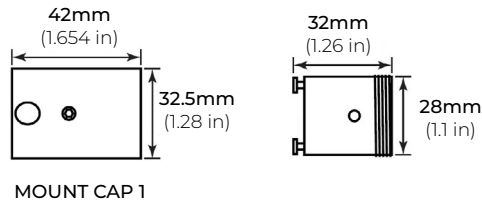
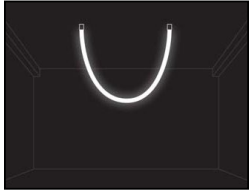

SURFACE PENDANT (SF)

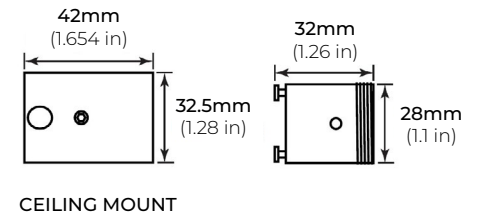
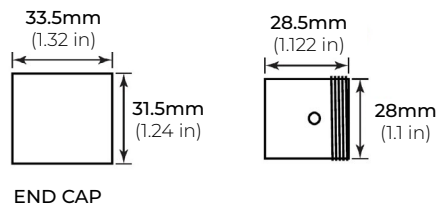
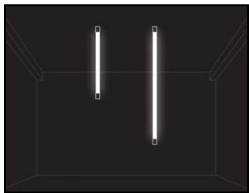

SUSPENDED PENDANT (SUP)

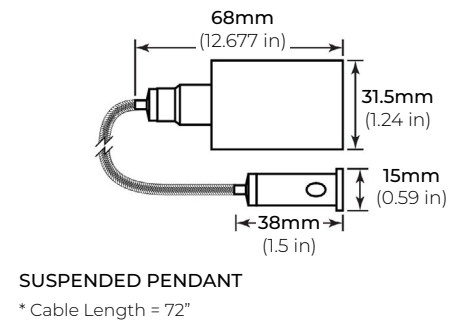
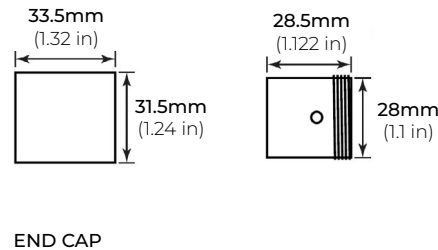
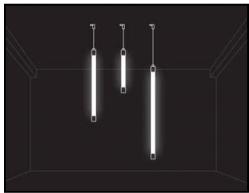

SUSPENSION CABLE SUPPORT (SCS)

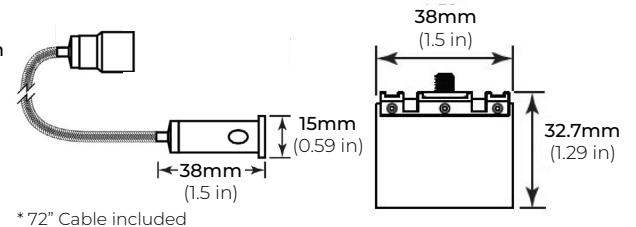
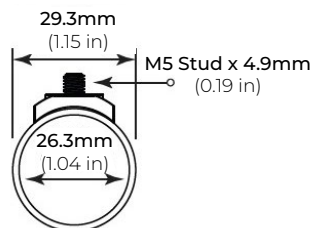
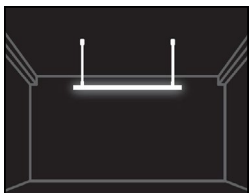

SLINQ

FLEXIBLE 360° ROUND NEON SERIES

MOUNTING OPTIONS

SUSPENSION JOINER SUPPORT (SJS)

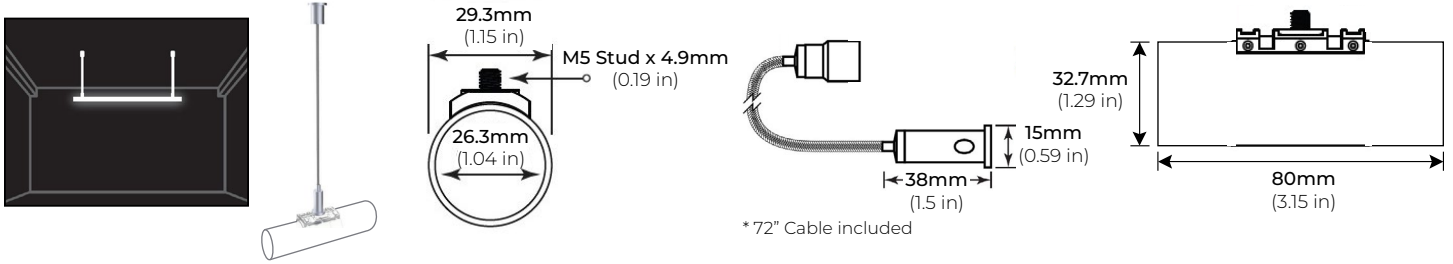

TELESCOPIC EXTENSION SUPPORT (TES)

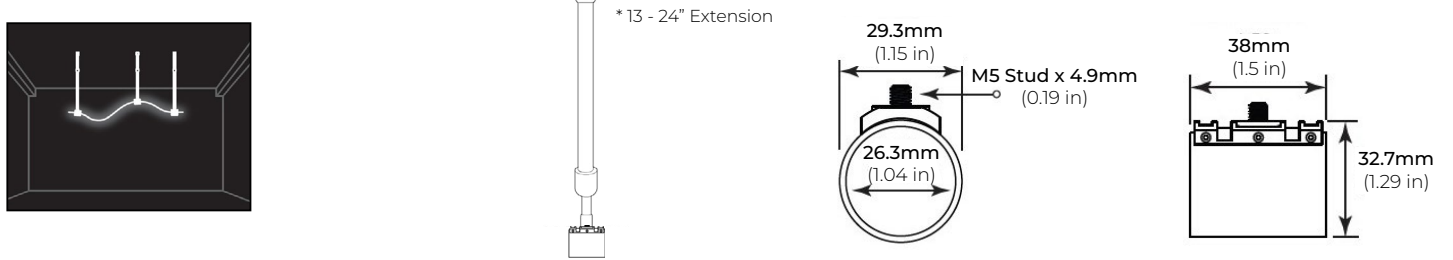

TELESCOPIC JOINER SUPPORT (TJS)

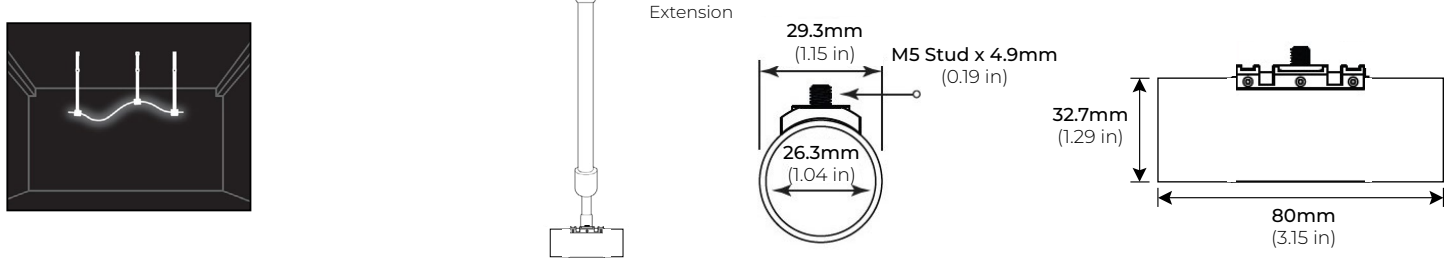

SLINQ

FLEXIBLE 360° ROUND NEON SERIES

ACCESSORIES

SLQ25-RSM-WH
WHITE RECESSED MOUNT KIT
Ø64MM x 20mm (D x H)

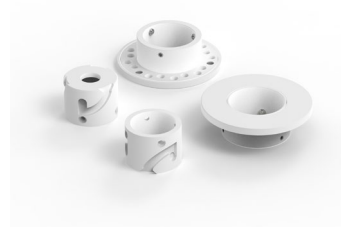

SLQ25-TSM-WH
WHITE TRIMLESS MOUNT KIT
Ø62MM x 20mm (D x H)

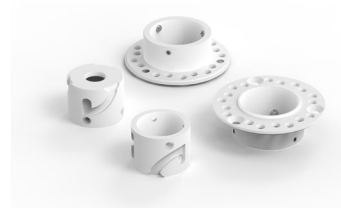

SLQ25-VMC
VISIBLE MOUNTING CLIP

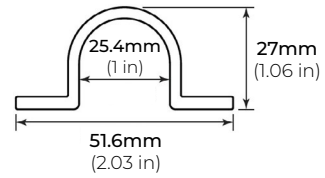

SLQ25-DMB
DISCREET MOUNTING BRACKET

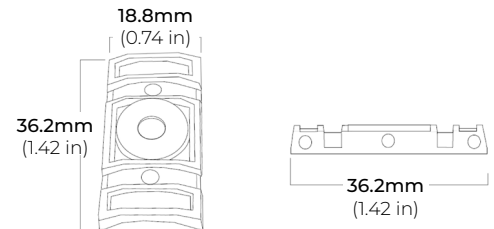

SLQ25-IJ
INFINITY JOINER

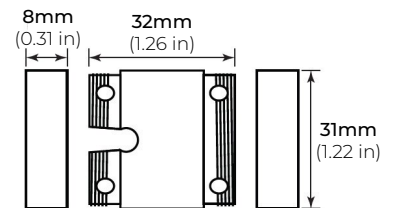
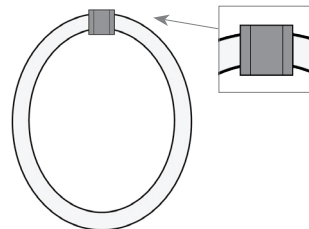

FLEXIBLE 360° ROUND NEON SERIES

ACCESSORIES

SLQ25-RTS-39-S
39" RIGID TUBE

SLQ25-RTS-78-S
78" RIGID TUBE

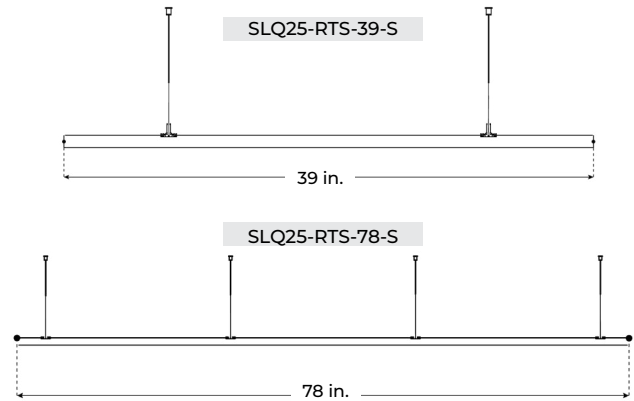

ROUND PLATE SUSPENSION KIT

SLQ25-RPS-BK SMALL ROUND PLATE (BLACK)
SLQ25-RPM-BK MEDIUM ROUND PLATE (BLACK)
SLQ25-RPL-BK LARGE ROUND PLATE (BLACK)

SLQ25-RPS-WH SMALL ROUND PLATE (WHITE)
SLQ25-RPM-WH MEDIUM ROUND PLATE (WHITE)
SLQ25-RPL-WH LARGE ROUND PLATE (WHITE)

*SCREWS INCLUDED

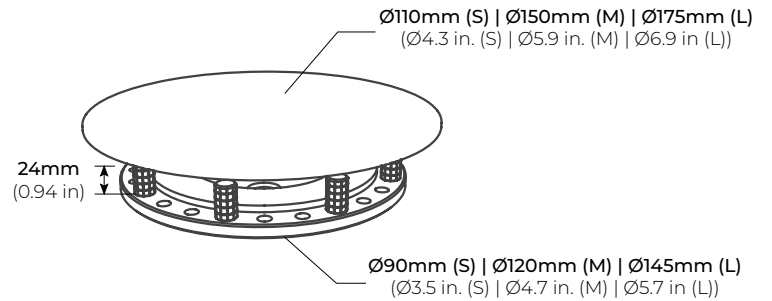

DIMENSIONS

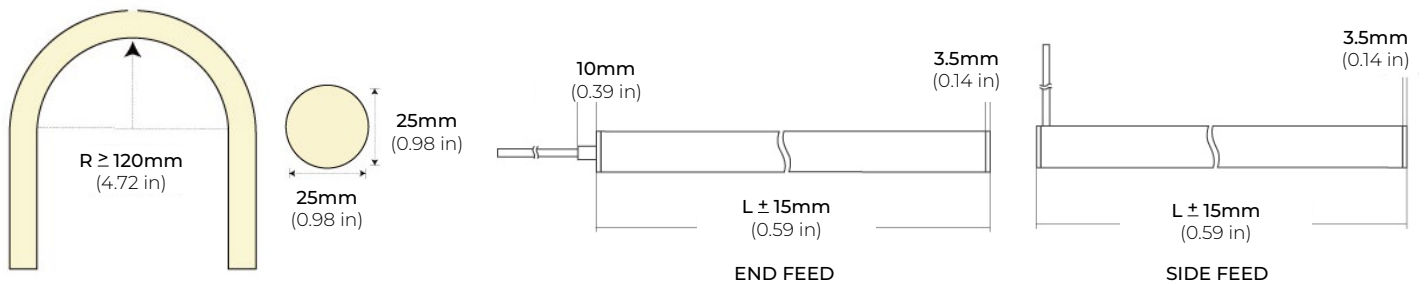

FLEXIBLE 360° ROUND NEON SERIES

COMPATIBLE 24V TRANSFORMERS

PSDL SERIES TRIAC DIMMABLE

PSDL-30W-24V	CLASS 2	6.5" X 3.63" X 1.58"
PSDL-60W-24V	CLASS 2	7.4" X 3.63" X 1.58"
PSDL-96W-24V	CLASS 2	8.67" X 3.67" X 1.62"
PSDL-150W-24V		10.25" X 4.06" X 1.82"
PSDL-192W-24V	CLASS 2	11" X 4" X 1.82"
PSDL-200W-24V		10.25" X 4.06" X 1.82"
PSDL-288W-24V	CLASS 2	11.85" X 4.25" X 1.82"
PSDL-300W-24V		10.25" X 4.06" X 1.82"

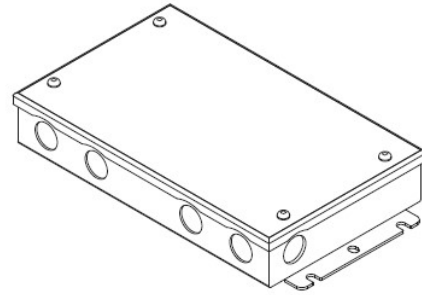

PSDH SERIES HIGH PERFORMANCE MAGNETIC LOW VOLTAGE (MLV)

PSDH-48W-24V	CLASS 2	11.25" X 3.38" X 3.38"
PSDH-96W-24V	CLASS 2	11.25" X 3.38" X 3.37"
PSDH-288W-24V	CLASS 2	14.25" X 8.43" X 4.43"

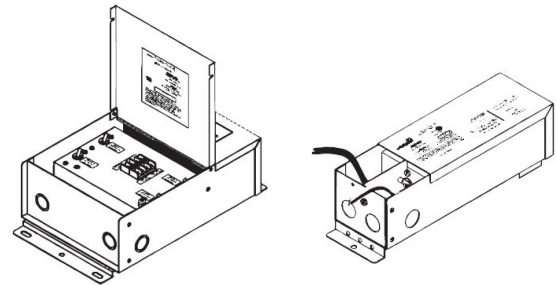

PSRX SERIES 4-IN-1 DIMMING DRIVER W/ JUNCTION BOX

PSRX-30W-24V-UNV	CLASS 2	6.5" X 3.7" X 1.57"
PSRX-60W-24V-UNV	CLASS 2	7.4" X 3.72" X 1.57"
PSRX-96W-24V-UNV	CLASS 2	8.66" X 3.72" X 1.57"
PSRX-150W-24V-UNV		10.24" X 4.13" X 1.77"
PSRX-192W-24V-UNV	CLASS 2	11" X 4" X 1.82"
PSRX-200W-24V-UNV		10.24" X 4.13" X 1.77"
PSRX-288W-24V-UNV	CLASS 2	11.85" X 4.25" X 1.82"
PSRX-300W-24V-UNV		10.94" X 4.33" X 1.77"

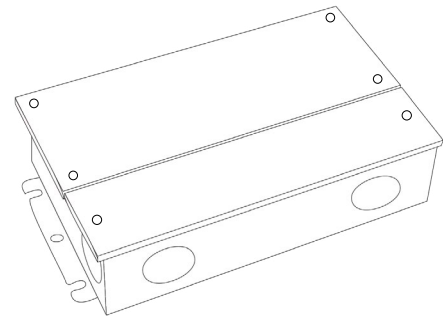

LUTRON 1% 3-WIRE DIMMING

L3DA4U1UKL-CV240	CLASS 2	4.89" X 4" X 2.62"
------------------	---------	--------------------

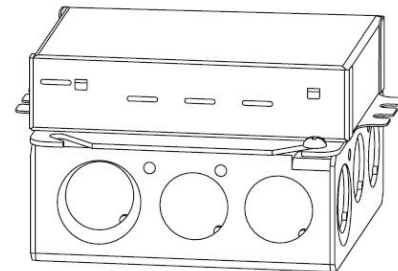

FLEXIBLE 360° ROUND NEON SERIES

COMPATIBLE 24V TRANSFORMERS

LUTRON 1%

PSDE-96W-24V-ECO CLASS 2 10.5" X 3.0" X 2.0"

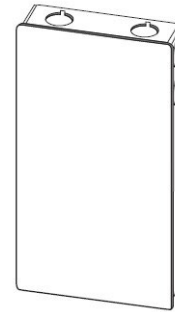

COMPATIBLE 24V NON-DIMMING DRIVERS

PSHK SERIES

NON-DIMMING CONSTANT VOLTAGE WITH JUNCTION BOX

PSHK-30W-24V	CLASS 2	6.5" X 3.6" X 1.02"
PSHK-60W-24V	CLASS 2	7.4" X 3.62" X 1.02"
PSHK-96W-24V	CLASS 2	8.66" X 3.66" X 1.61"
PSHK-150W-24V		10.24" X 4.06" X 1.81"
PSHK-200W-24V		10.24" X 4.06" X 1.81"
PSHK-288W-24V	CLASS 2	11.85" X 4.25" X 1.82"
PSHK-300W-24V		10.24" X 4.25" X 1.81"

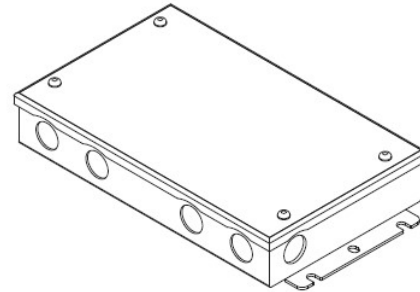

COMPATIBLE 48V TRANSFORMERS

PSRX SERIES

4-IN-1 DIMMING DRIVER W/ JUNCTION BOX

PSRX-200W-48V-UNV	10.24" X 4.13" X 1.77"
PSRX-300W-48V-UNV	10.24" X 4.13" X 1.77"

