

INSTALLATION GUIDE



PRE-INSTALLATION

Recessed Mount

Disconnect power source prior to installation.

DIMENSIONS

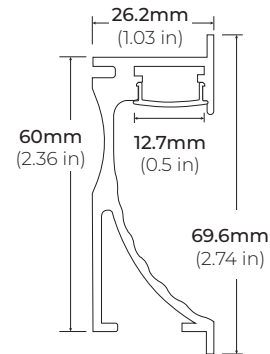

SAFETY

Read all instructions before installation.

These products may represent a possible shock or fire hazard if improperly installed.

Do not look directly into light.



Product should be installed by a qualified electrician.



Product should be installed in accordance with these instructions and current electrical codes.

INSTALLATION

STEP 1

Determine where to install the profile and make a slot equal to the profile's dimensions with an additional tolerance of 0.5mm. (Figure 1)

STEP 2

Run wiring to main power supply. (Figure 2)
Install main power supply at a proper location.

STEP 3

Carefully drill an exit hole for the LED strip wires through either the profile end cap (Figure 3A) or the base of the profile (Figure 3B).

STEP 4

Peel off the adhesive backing of the LED strip and install the LED strip onto the channel. (Figure 4)
Make sure that the LED strip is laid evenly flat on the channel. This will avoid having any dark spots once lit up.

STEP 5

Carefully mount the lens onto the profile. The lens will snap shut when it is fully set into place. (Figure 5)

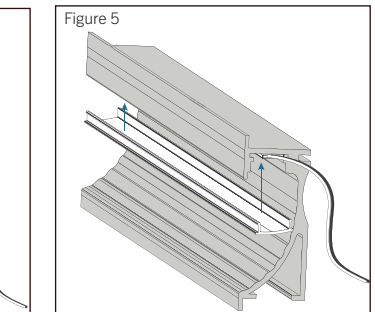
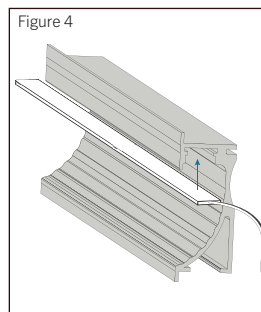
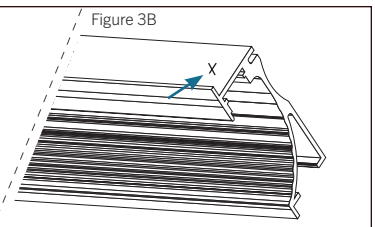
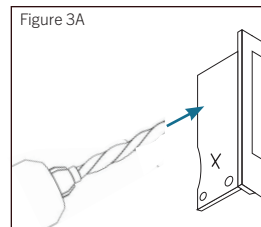
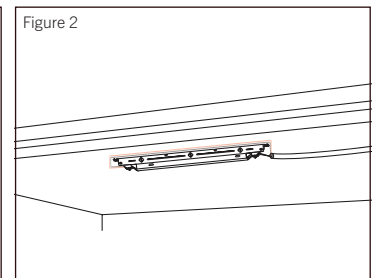
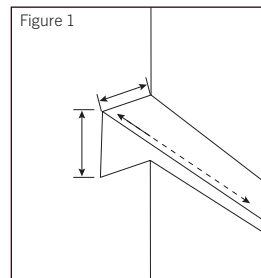

INSTALLATION (CONT.)

STEP 5

Carefully route the LED strip wires through the designated exit hole drilled in Step 3.
Install the profile end caps and secure in place with screws.

STEP 6

Make the required wire connections according to the wiring guide of your selected power supply, dimmer, or other components.
(Figure 6)

STEP 7

Apply glue to the slot surface where the profile will be installed, then press the profile firmly into place (Figure 7A/ Figure 7B)

