

# LSMW-40WD-10MM

## 4W OUTDOOR AUTO WARM-DIM FLEXIBLE LED STRIP

Project \_\_\_\_\_  
Location \_\_\_\_\_  
Quote/ Ref # \_\_\_\_\_

**LSMW-40WD** is a new warm-dim LED strip with smart chip technology. Using a standard wall box dimmer, LED light source automatically shifts color temperature from 3000K down to 1800K as it is being dimmed. LSMW-40WD provides Warm-Dim technology at a fraction of the price without the need for any special lighting control system.

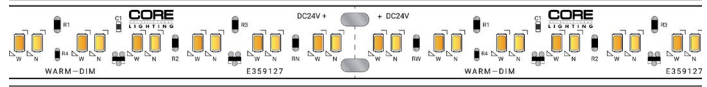

### SPECIFICATIONS

|                       |                               |
|-----------------------|-------------------------------|
| INPUT VOLTAGE         | 24V DC                        |
| POWER CONSUMPTION     | 4W per Ft.                    |
| NO. OF LEDS           | 64 LEDs per Ft.               |
| LUMEN OUTPUT          | 253 Lm/Ft.                    |
| CRI                   | 95+                           |
| DIMMING/ CONTROL      | MLV, ELV, 0-10 and TRIAC      |
| MAXIMUM RUN LENGTH    | 12 Ft.                        |
| FIELD CUTTABLE        | Every 2.4 in (61.1mm)         |
| BINNING               | 1.5 Step Macadam Elipse       |
| OPERATING TEMPERATURE | -40°F (-40°C) ~ 140°F (60°C)  |
| BEAM ANGLE            | 120°                          |
| IP RATING             | IP65 wet location (outdoor)   |
| CERTIFICATIONS        | UL Listed, TITLE 24 JA8, RoHS |
| LUMEN MAINTENANCE     | 50,000 Hrs.                   |

\*Approved for closet / storage space installation per NEC 410.16(A)(3) and 410.16(C)(5)



| MODEL    | COLOR TEMP                    | LENGTH                | VOLTAGE             | PROFILE                             |
|----------|-------------------------------|-----------------------|---------------------|-------------------------------------|
| LSMW40WD | <b>18/27K</b><br>1800K/ 2700K | <b>1XX</b><br>per Ft. | <b>24</b><br>24V DC | See Page 3 for compatible profiles. |
|          | <b>18/30K</b><br>1800K/ 3000K |                       |                     |                                     |

\*1 = Custom length per FT.  
(Cuttable every 2.4")

\* Custom color finishes require powder coating. Allow 7 days leads time.

# LSMW-40WD-10MM

## 4W OUTDOOR AUTO WARM-DIM FLEXIBLE LED STRIP

### DIMENSIONS

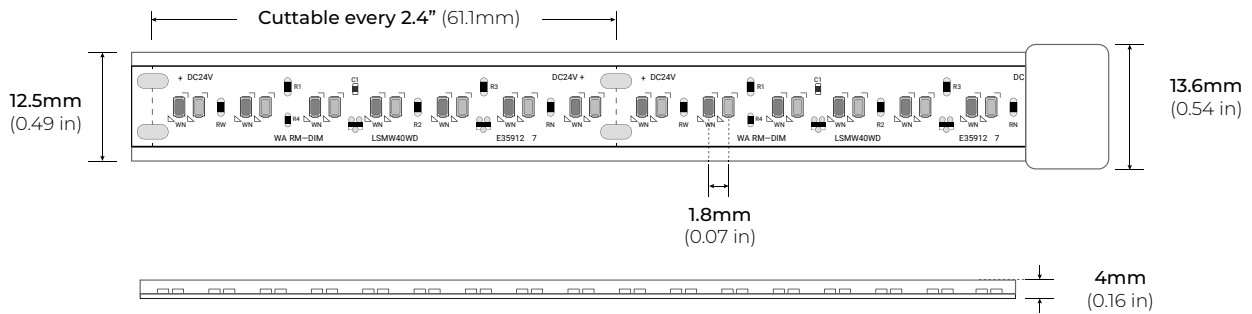

### COMPATIBLE ALUMINUM PROFILES

#### SURFACE PROFILES

##### ALU-DS100

LENGTHS 39" | 78" | 84"  
LENS Clear, Frosted  
FINISH Silver

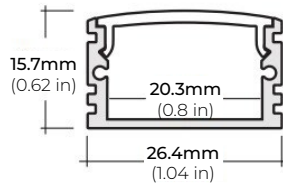

##### ALP-80

LENGTHS 49.25" | 98.5"  
LENS Frosted  
FINISH Silver

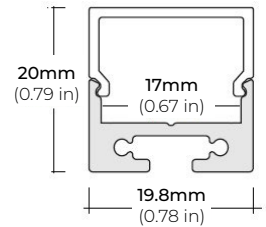

##### ALP-90

LENGTHS 48" | 96"  
LENS Frosted  
FINISH Black | Silver

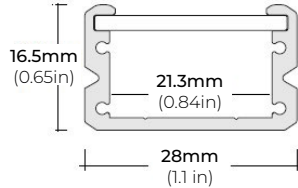

##### ALP-100C (CORNER)

LENGTHS 48" | 98"  
LENS Frosted  
FINISH Silver

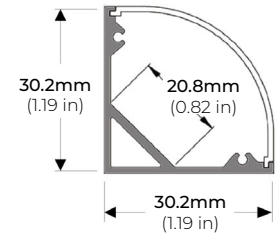

##### ALP-102

LENGTHS 49" | 98"  
LENS Frosted, Black, Asymmetric, Double Asymmetric  
FINISH Silver

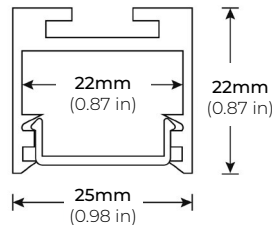

##### ALP-130

LENGTHS 49" | 84" | 98"  
LENS Frosted  
FINISH Silver | Black

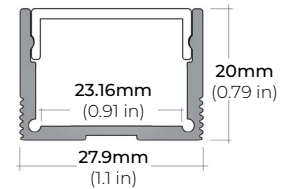

\* For more compatible profiles, visit [corelightingusa.com](http://corelightingusa.com)

#### RECESSED PROFILES

##### ALP-210RN

LENGTHS 49" | 98"  
LENS Frosted  
FINISH Silver

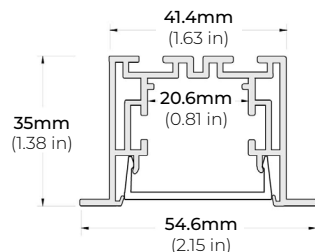

##### ALP-230RN

LENGTHS 49" | 98"  
LENS Frosted  
FINISH Silver

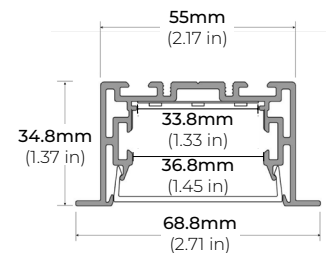

\* For more compatible profiles, visit [corelightingusa.com](http://corelightingusa.com)

# LSMW-40WD-10MM

## 4W OUTDOOR AUTO WARM-DIM FLEXIBLE LED STRIP

### COMPATIBLE TRANSFORMERS

#### PSDL SERIES TRIAC DIMMABLE

|               |         |                        |
|---------------|---------|------------------------|
| PSDL-30W-24V  | CLASS 2 | 6.5" X 3.63" X 1.03"   |
| PSDL-60W-24V  | CLASS 2 | 7.4" X 3.63" X 1.03"   |
| PSDL-96W-24V  | CLASS 2 | 8.67" X 3.67 X 1.62"   |
| PSDL-150W-24V |         | 8.67" X 3.67" X 1.62"  |
| PSDL-192W-24V | CLASS 2 | 10.25" X 4.06" X 1.82" |
| PSDL-200W-24V |         | 10.25" X 4.06" X 1.82" |
| PSDL-288W-24V | CLASS 2 | 10.25" X 4.06" X 1.82" |
| PSDL-300W-24V |         | 10.25" X 4.06" X 1.82" |

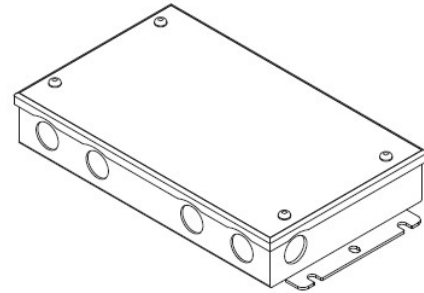

#### PSDH SERIES HIGH PERFORMANCE MAGNETIC LOW VOLTAGE (MLV)

|               |         |                        |
|---------------|---------|------------------------|
| PSDH-48W-24V  | CLASS 2 | 11.25" X 3.37" X 3.25" |
| PSDH-96W-24V  | CLASS 2 | 11.25" X 3.37" X 3.25" |
| PSDH-288W-24V | CLASS 2 | 14.25" X 8.43" X 4.43" |

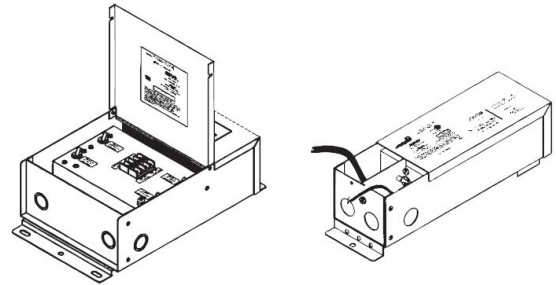

#### PSRX SERIES 4-IN-1 DIMMING DRIVER

|               |         |                        |
|---------------|---------|------------------------|
| PSRX-30W-24V  | CLASS 2 | 6.5" X 3.72" X 1.57"   |
| PSRX-60W-24V  | CLASS 2 | 7.4" X 3.72" X 1.57"   |
| PSRX-96W-24V  | CLASS 2 | 8.66" X 3.72" X 1.57"  |
| PSRX-150W-24V |         | 10.24" X 4.13" X 1.77" |
| PSRX-192W-24V | CLASS 2 | 11" X 4" X 1.82"       |
| PSRX-200W-24V |         | 10.24" X 4.13" X 1.77" |
| PSRX-288W-24V | CLASS 2 | 11.85" X 4.25" X 1.82" |
| PSRX-300W-24V |         | 10.94" X 4.33" X 1.77" |

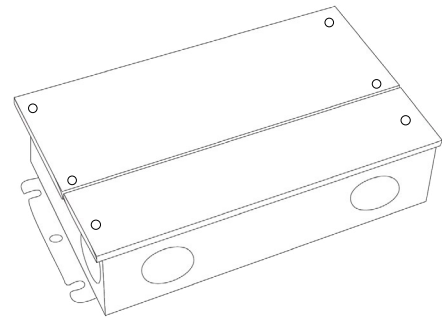

#### PSVT SERIES 0-10V DIMMING DRIVER

|               |         |                        |
|---------------|---------|------------------------|
| PSVT-60W-24V  | CLASS 2 | 7.4" X 3.72" X 1.57"   |
| PSVT-96W-24V  | CLASS 2 | 8.66" X 3.72" X 1.57"  |
| PSVT-200W-24V |         | 10.24" X 4.13" X 1.77" |
| PSVT-288W-24V | CLASS 2 | 11.85" X 4.25" X 1.81" |
| PSVT-300W-24V |         | 10.94" X 4.33" X 1.77" |

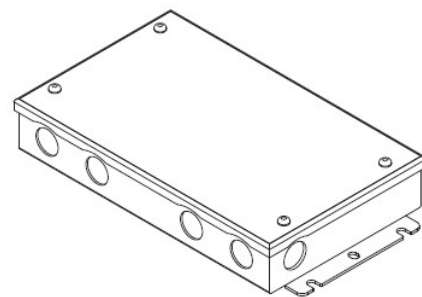

# LSMW-40WD-10MM

## 4W OUTDOOR AUTO WARM-DIM FLEXIBLE LED STRIP

### COMPATIBLE TRANSFORMERS

---

PSDE SERIES  
0-10V DIMMING W/ JUNCTION BOX

|                     |         |                      |
|---------------------|---------|----------------------|
| PSDE-60W-24V-010-JB | CLASS 2 | 12.1" X 2.36" X 1.4" |
| PSDE-96W-24V-010-JB | CLASS 2 | 12.1" X 2.36" X 1.4" |

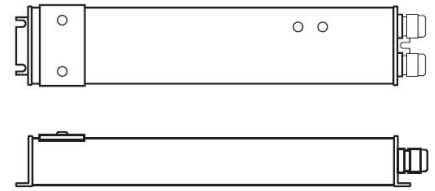

LUTRON 1%  
3-WIRE DIMMING

|                  |         |                    |
|------------------|---------|--------------------|
| L3DA4U1UKL-CV240 | CLASS 2 | 4.89" X 4" X 2.62" |
|------------------|---------|--------------------|

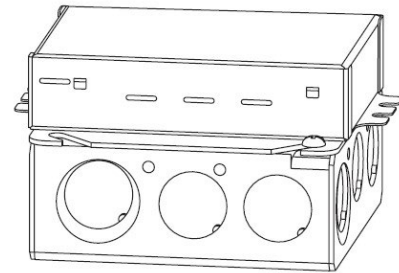

LUTRON 1%

|                  |         |                     |
|------------------|---------|---------------------|
| PSDE-96W-24V-ECO | CLASS 2 | 10.5" X 3.0" X 2.0" |
|------------------|---------|---------------------|

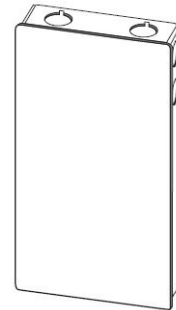

### COMPATIBLE NON-DIMMING DRIVERS

---

PSHK SERIES  
NON-DIMMING CONSTANT VOLTAGE WITH JUNCTION BOX

|               |         |                        |
|---------------|---------|------------------------|
| PSHK-30W-24V  | CLASS 2 | 6.5" X 3.6" X 1.02"    |
| PSHK-60W-24V  | CLASS 2 | 7.4" X 3.62" X 1.02"   |
| PSHK-96W-24V  | CLASS 2 | 8.66" X 3.66" X 1.61"  |
| PSHK-150W-24V |         | 10.24" X 4.06" X 1.81" |
| PSHK-200W-24V |         | 10.24" X 4.06" X 1.81" |
| PSHK-288W-24V | CLASS 2 | 11.85" X 4.25" X 1.82" |
| PSHK-300W-24V |         | 10.24" X 4.25" X 1.81" |

