

INSTALLATION GUIDE



PRE-INSTALLATION

Surface Mount

Power input is 100V - 277V AC. Confirm the source voltage is compatible.

Disconnect power source prior to installation.

DIMENSIONS

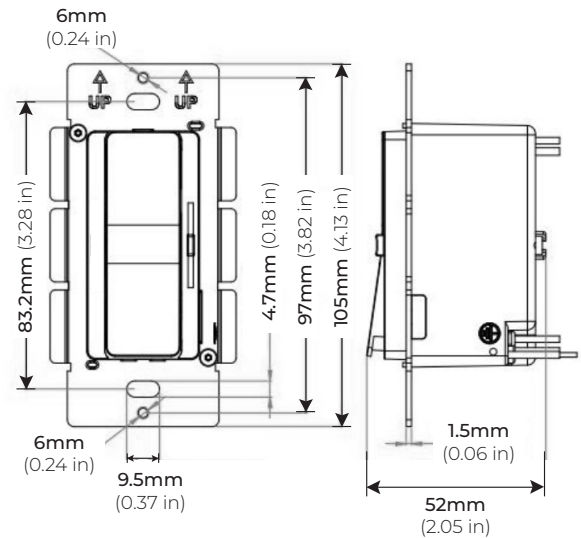

SAFETY

Read all instructions before installation.

These products may represent a possible shock or fire hazard if improperly installed.

Do not install less than 6 inches from a combustible material.

Do not install less than 5 feet above the ground.



Product should be installed by a qualified electrician.



Product should be installed in accordance with these instructions and current electrical codes.

INSTALLATION

STEP 1 Turn the power off at the circuit breaker. (Figure 1)

STEP 2 Determine the location of the dimmer.
* If removing existing switch, remove the trim plate and mounting screws and disconnect the wires from the switch before pulling the switch from the wall. (Figure 2)
* If using multiple dimmers, break off the side fins so both dimmers can securely install with each other. (Figure 3)

Figure 1

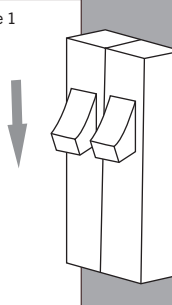

Figure 2

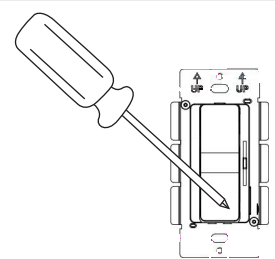
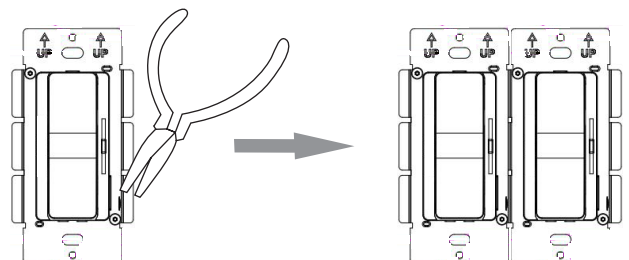

Figure 3



INSTALLATION

STEP 3

Strip the wires on the driver, and wire the driver to the vertical voltage partition installed to the wall box. (Figure 4)

**Use wires that are rated for at least 300V.*

**Wall box and vertical partition must comply with UL514C article 6 requirements.*

STEP 4

If changing the face plate finish, position the face plate sliders at minimum brightness (the bottom level). Then, gently squeeze the top and bottom of the face plate, and lift the face plate from the bottom housing. (Figure 5A)

**To add the desired face plate finish, insert the face plate into the top housing groove and snap it into the bottom housing.*

If switching between Forward Phase or Reverse Phase, take off the face plate and set the switch upward for Forward Phase, or downward for Reverse Phase. (Figure 5B)

If adjusting the minimum brightness, use the dial on by the bottom left corner of the dimmer to increase or decrease the minimum brightness to the preferred settings. (Figure 5C)

STEP 5

Mount the driver to the wall box with screws, then mount the wall plate to the driver. (Figure 6)

STEP 6

Turn the power back on at the circuit breaker. (Figure 7)

Figure 4

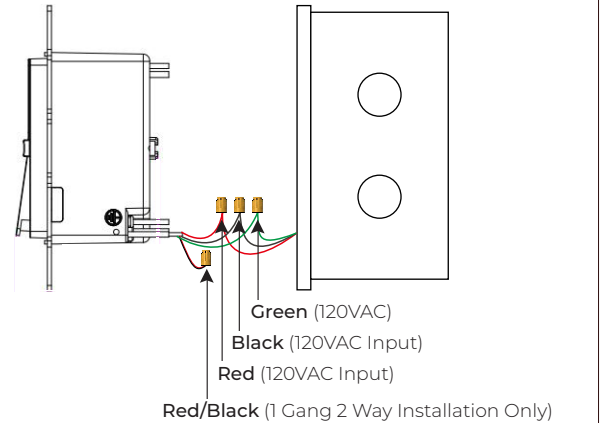

Figure 5A

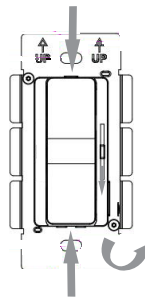

Figure 5B

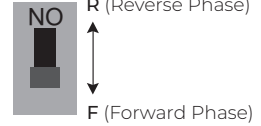

Figure 5C

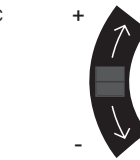

Figure 6

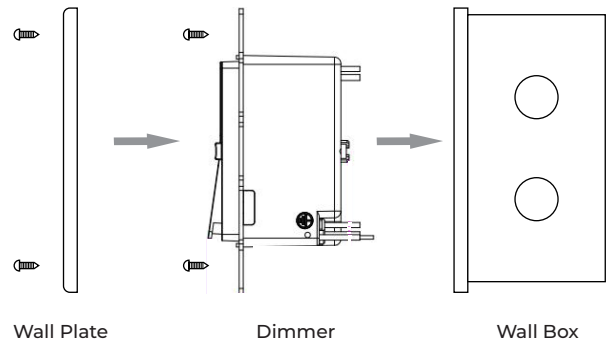

Figure 7

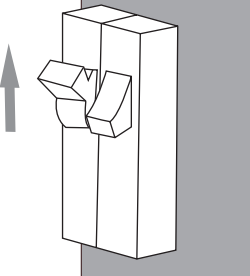

Figure 8

