

INSTALLATION GUIDE

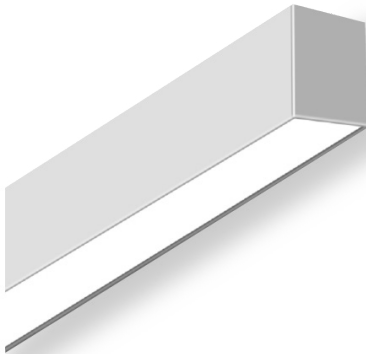

DIMENSIONS

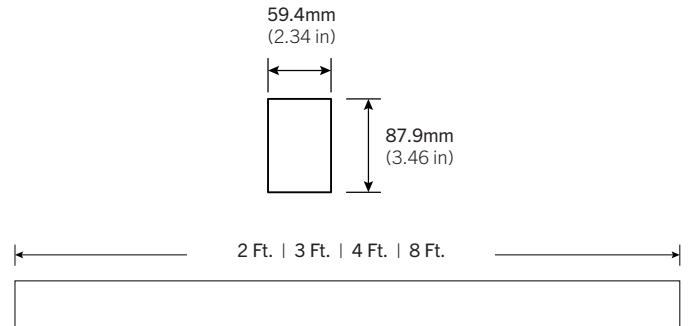

PRE-INSTALLATION

Wall Mount

Disconnect power source prior to installation.

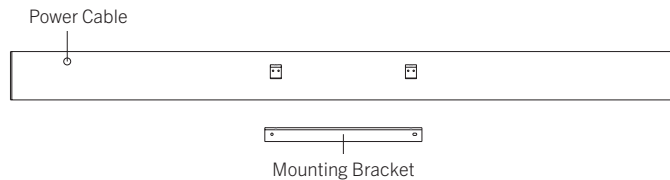

SAFETY

Read all instructions before installation.

These products may present a possible shock, serious injury, or death if improperly installed.

Do not install in wet locations.

Do not cover fixture with heat insulation gasket or similar materials.

- Product should be installed by a qualified electrician.
- Product should be installed in accordance with these instructions and current electrical codes.
- To reduce the risk of fire or overheating, all connections should be tight and secure.

INSTALLATION

STEP 1

Remove the end cap and LED modular from the fixture housing. Thread the main power cord through the Power Cable hole, located at the back of the fixture and connect the wires with the corresponding colors. (Figure 1)

Once wired, re-secure the LED modular and end cap back in place.

STEP 2

Mark your chosen surface to map out the planned installation and align the Echo 300 fixture.

Drill Ø0.2" holes for mounting. (Figure 2)

* See chart for factory recommended measurements.

STEP 3

Insert anchor plugs into the drilled mounting holes on the wall and secure the provided mounting bracket in place using screws. (Figure 3)

STEP 4

Using the provided mounting plate, cover the junction box and secure in place with appropriate screws.

Plaster over the mounting plate. (Figure 3)

Figure 1

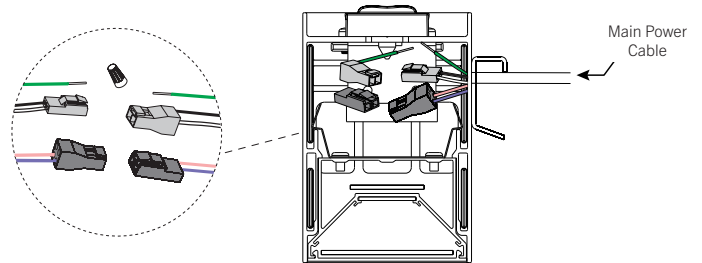
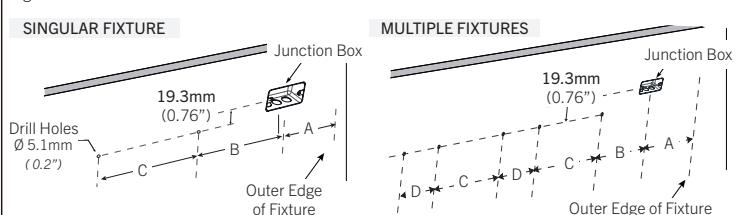

Figure 2



Fixture Length	FROSTED REGRESSED				LOUVER			
	A (FT.)	B (FT.)	C (FT.)	D (FT.)	A (FT.)	B (FT.)	C (FT.)	D (FT.)
2 Ft.	0.34	0.22	0.85	1.11	0.34	0.25	0.85	1.12
3 Ft.	0.34	0.72	0.85	2.11	0.34	0.72	0.85	2.10
4 Ft.	0.34	1.22	0.85	3.11	0.34	1.12	0.85	3.08
8 Ft.	0.34	3.20	0.85	7.07	0.34	3.18	0.85	7.02

INSTALLATION

STEP 4

Wire accordingly, connecting the male and female quick connectors (or corresponding AC, Dimming, and Ground wires) together. (Figure 4)
Hide all wires inside the junction box.

STEP 5

Match the hole position of the fixture and wall mounting bracket. Mount the fixture onto the wall and secure in place with screws. (Figure 5A)

**If mounting onto a wooden frame or cement drywall, please use appropriate screws.*

Line Joiner

If creating a continuous run using a Straight Joiner (ECH-S300-ST), remove the end cap on the continuing end of the fixture housing and add the straight joiner. Secure in place with the appropriate screw.

**Tight enough for a secure fit, but not tight enough to damage the fixture housing.*

Repeat steps 1-5 if installing more than one fixture. (Figure 5B)

STEP 6

Attach the end cap at the end of the fixture run and secure in place with screws. (Figure 6)

Figure 3

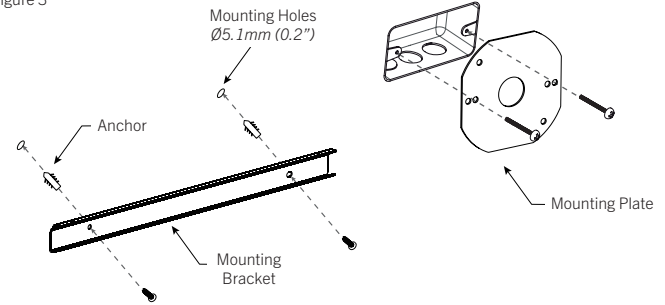

Figure 4

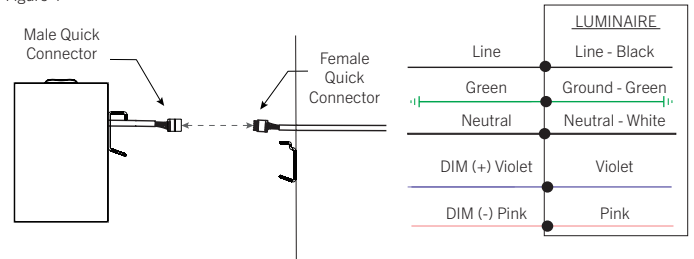

Figure 5A

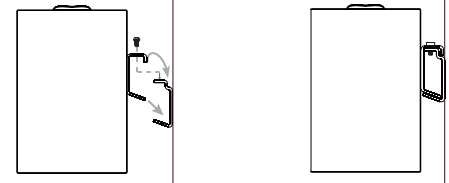

Figure 5B

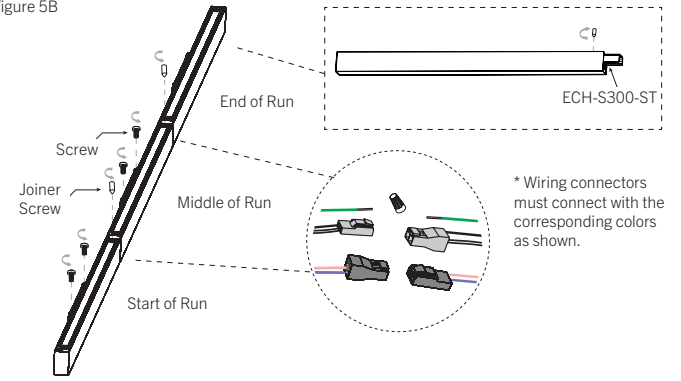

Figure 6

