

ALP-95T

1.25" WIDE SURFACE/ T-BAR APPLICATIONS LOW-PROFILE CHANNEL

Project _____
Location _____
Quote/ Ref # _____

The **ALP-95T** is an Architectural Grade LED extrusion profile designed for linear LED strips up to 18mm wide. Made from high-quality Aluminum, these extrusions provide superior thermal management for higher wattage LED strips and prolong the lighting system's lifespan. This surface mount profile is manufactured with a patented frosted diffuser for maximum lumen output and wide beam distribution. Included snap-on mounting brackets allow for an easy installation.



SPECIFICATIONS

TYPE	Surface/ Suspended Profile
LED STRIP	Fits LED strips up to 21mm (0.83 in)
LENGTHS	48"/ 96"
FINISH	Matte White
LENS	Frosted (Included)
CHANNEL	ALP95T
LENS	ALP95T-LN (Included)
END CAP	ALP95T-EC-WH (Included)
MOUNTING BRACKET	ALP95T-CL (Included)
T-BAR BRACKET	ALP95T-TB-WH (Sold separately)

FEATURES

- Customizable
- Field Cuttable
- Fits LED strips up to 21mm (0.83 in) wide
- Suitable for surface mount applications
- Frosted lens diffuser included
- Matte white powder coated finish
- Durable, military grade aluminum
- Protects LEDs from dust and other elements
- Dissipates heat from LEDs



MODEL	LENGTH	LENS	FINISH
ALP95T	48 48 In.	FR Frosted	WH White
	96 96 In.		

ALP-95T

1.25" WIDE SURFACE/ T-BAR APPLICATIONS LOW-PROFILE CHANNEL

DIMENSIONS

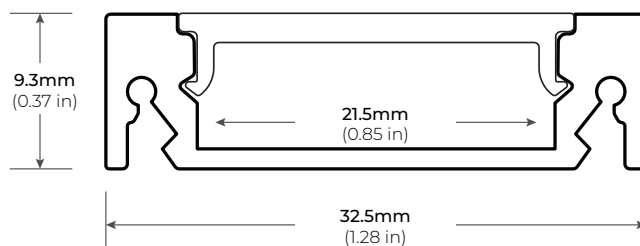

ACCESSORIES

ALP95T-EC-WH END CAP

*Two end caps included with every channel

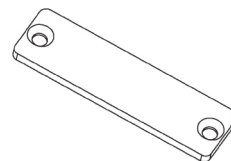

ALP95T-CL MOUNTING BRACKET

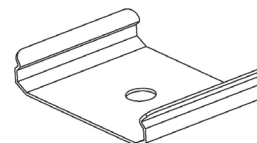

ALP95T-TB-WH T-BAR BRACKET

*Sold separately

