

ALP-350TL

Recessed Mount Trimless LED Profile

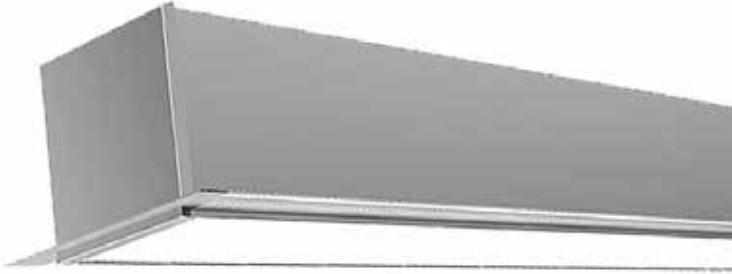

The ALP-350TL is a recessed, Architectural Grade LED extrusion profile designed for recessed linear LED applications. Made from high quality anodized aluminum, these fixtures provide superior thermal management for higher wattage LED strips and prolong the overall lifetime of your lighting system. The ALP-350TL is manufactured with a patented frosted diffuser for maximum lumen output and wide beam distribution. The ALP-350TL also helps protect LED's from dust and other undesirable elements, which can shorten the lifetime of the LED.

SPECIFICATIONS

TYPE	Trimless Recessed mount
AVAILABLE LENGTHS	49.25" and 98.5"
FINISH	Anodized Silver
LENS OPTIONS	Frosted
PROFILE	ALP-350TL
LENS	ALP-350TL-LN
END CAP	ALP-350TL-EC
L-CONNECTOR (OUTSIDE)	ALP-350TL-L90W
L-CONNECTOR (INSIDE)	ALP-350TL-L90N
L-CONNECTOR (SIDE)	ALP-350TL-L90
T-CONNECTOR	ALP-350TL-T90
X-CONNECTOR	ALP-350TL-X90
SEAMLESS CONNECTOR	ALP-SC

FEATURES

- Customizable
- Ideal for surface, suspended and recessed applications
- optional T, L and X connectors for corners and angles
- Durable, high-quality anodized aluminum
- Protects LED systems from dust and other elements
- Dissipates heat from LED, prolonging its lifetime

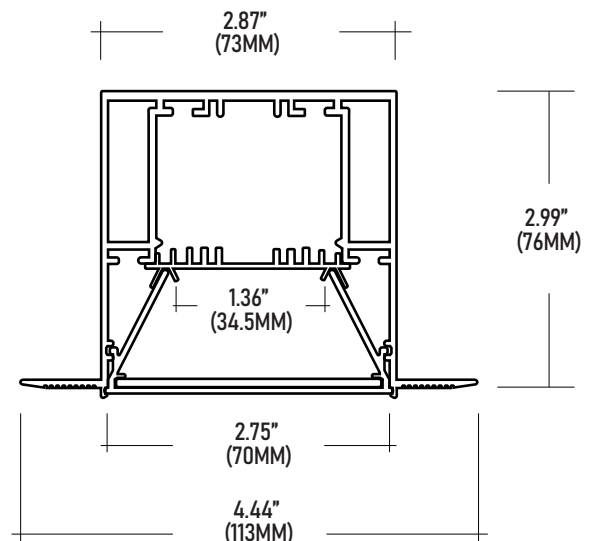

ALP-350TL

Recessed Mount Trimless LED Profile

STANDARD ORDERING GUIDE

Model	Channel Length	Lens Option
ALP-350TL	49 49.25 inches	FR Frosted
	98 98.5 inches	
	CC Custom cut	

NOTES:

Custom color finishes require powder coating. (Additional fees apply)
Allow 7 days lead time.

ALP-350TL

Recessed Mount Trimless LED Profile

ACCESSORIES

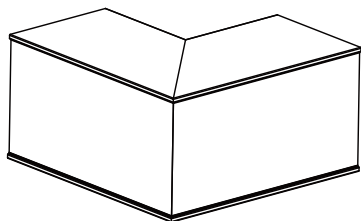

ALP-350TL-L90W
L connector (OUTSIDE)

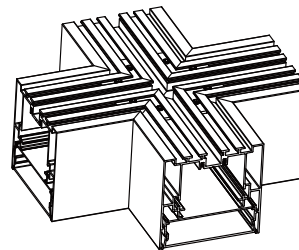

ALP-350TL-X90
X connector

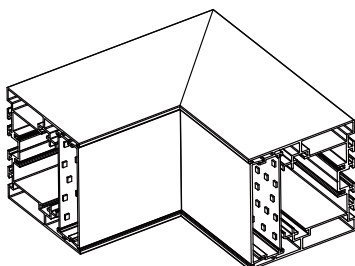

ALP-350TL-L90N
L connector (INSIDE)

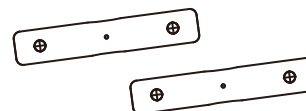

ALP-SC
Seamless connector

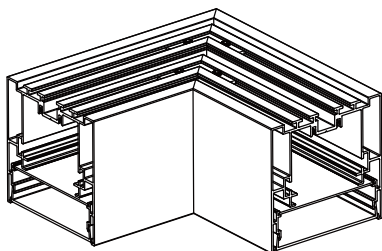

ALP-350TL-L90
L connector (SIDE)

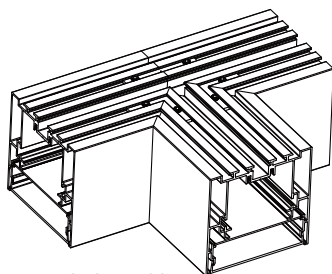

ALP-350TL-T90
T connector