

LSM55RGBW

5.0W Indoor Color-Changing + White LED Strip

CORE
ARCHITECTURAL
LIGHTING

JOB NAME: _____
LOCATION: _____
QUOTE/REF#: _____

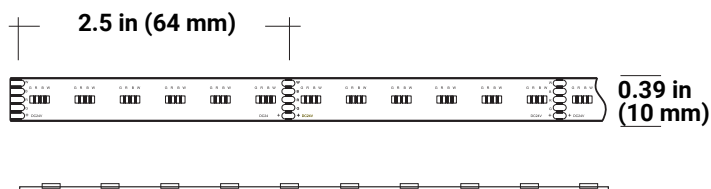

LSM55RGBW series is a flexible color-changing LED strip that provides the perfect lighting solution for spaces that require dynamic full color and white LED illumination. The warm white LED's combined with the full color spectrum of the RGB light array produces more powerful color options that's sure to please even the most discerning lighting designer.

SPECIFICATIONS

INPUT VOLTAGE	24V DC
POWER CONSUMPTION	5.0W per foot
LUMEN OUTPUT	310 lm
NO. OF LEDs	128 LEDs per foot
BEAM ANGLE	120°
CRI	90+
DIMMING	Through RGB controller
MAXIMUM RUN LENGTH	16 feet
FIELD CUTTABLE	Every 2.5" (64MM)
IP RATING	Indoor, dry location (indoor)
LUMEN MAINTENANCE	50,000 hrs.
OPERATING TEMPERATURE	-40°F(-40°C)~+140°F(+60°C)
STORAGE TEMPERATURE	-40°F(-40°C)~+140°F(+60°C)
CERTIFICATIONS	UL listed, TITLE 24 JA8
DIMENSIONS	0.39" x 0.18" (width x height)

FEATURES

- 5.0W per Foot
- 310 Lumens
- 90 CRI
- California TITLE 24 JA8 compliant
- Field cuttable
- Suitable for accent or ambient lighting
- Indoor rated
- Superior COLOR RENDERING INDEX (CRI)
- UL Listed
- Approved for closet / storage space installation per NEC 410.16(A)(3) and 410.16(C)(5)

RGBW COLOR SPECTRUM



LSM55RGBW

5.0W Indoor Color-Changing + White LED Strip

STANDARD ORDERING CODE

Model	Color Temperature	Length	Voltage	Profile
LSM55	RGBW27K RGBW + 2700K	10 10 Ft.	24 24 Volts	²See p3 for options
	RGBW30K RGBW + 3000K	20 20 Ft.		
	RGBW40K RGBW + 4000K	1'XX per Ft.		
	RGBW50K RGBW + 5000K			

LSM55RGBW

5.0W Indoor Color-Changing + White LED Strip

COMPATIBLE ALUMINUM PROFILES

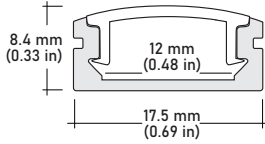

ALU-SF Surface
LENGTHS 39^{3/8}" | 78^{7/8}" | 98"
LENS Clear, Frosted
FINISH Silver | Black

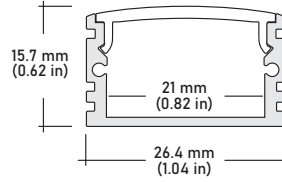

ALU-DS100 Surface Wide
LENGTHS 39^{3/8}" | 78^{7/8}" | 96"
LENS Clear, Frosted
FINISH Silver

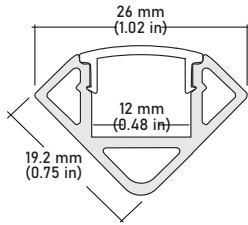

ALU-CN Surface, Corner
LENGTHS 39^{3/8}" | 78^{7/8}" | 96"
LENS Clear, Frosted
FINISH Silver | Black

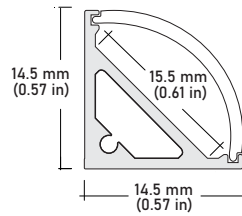

ALU-50C Surface, Corner
LENGTHS 49.25" | 98.5"
LENS Frosted
FINISH White | Black | Silver

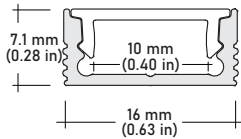

ALP-20 Surface
LENGTHS 49.25" | 98.5"
LENS Frosted
FINISH White | Black | Silver

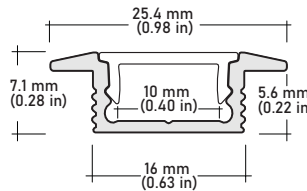

ALP-20R Recessed
LENGTHS 49.25" | 98.5"
LENS Frosted
FINISH White | Black | Silver

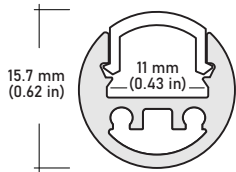

ALP-35 Surface
LENGTHS 48" | 96"
LENS Frosted
FINISH Silver

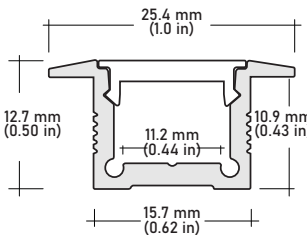

ALP-60R Recessed
LENGTHS 49.25" | 98.5"
LENS Frosted
FINISH White | Black | Silver

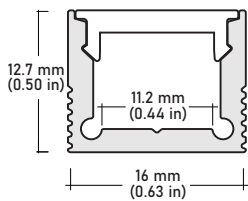

ALP-60 Surface
LENGTHS 49.25" | 98.5"
LENS Frosted
FINISH White | Black | Silver

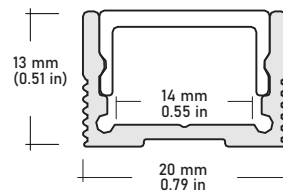

ALP-70 Surface
LENGTHS 49.25" | 98.5"
LENS Frosted
FINISH White | Black | Silver

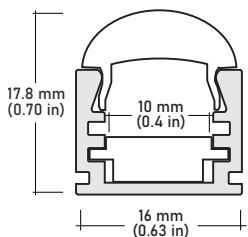

ALP-65 Surface
LENGTHS 49.25" | 98.5"
LENS Frosted
FINISH Silver
OPTICS 10° | 30° | 60°

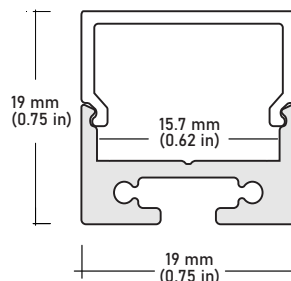

ALP-80 Surface, Suspended
LENGTHS 49.25" | 98.5"
LENS Frosted
FINISH Silver

LSM55RGBW

5.0W Indoor Color-Changing + White LED Strip

COMPATIBLE WALL CONTROLLERS



RGB-CT600 MULTI-FUNCTION RGBW WALL CONTROLLER

INPUT VOLTAGE	5V DC, 1A
OUTPUT SIGNAL	RF 2.4GHz + DMX512
CONTROL	4 ZONES
WORKING TEMP	-20°C ~ 40°C
DIMENSIONS	LxWxH (5.19"x 7.08"x 1.38")



RGB-SDE3 MULTI-FUNCTION RGBW WALL CONTROLLER

INPUT POWER	6V DC 0.6A
OUTPUT SIGNAL	DMX512 (x2)
PROGRAMMABILITY	PC, MAC, Tablet, Smartphone
AVAILABLE COLORS	Black / White
CONNECTIONS	USB, Ethernet, RS232, Clock, 8dry contact ports, 5V output relay
MEMORY	microSD card
WORKING TEMP	-10°C ~ 45°C
WEIGHT (gross)	247g
DIMENSIONS	LxWxH (5.75"x 4.17"x 0.43")

COMPATIBLE DMX RECEIVERS

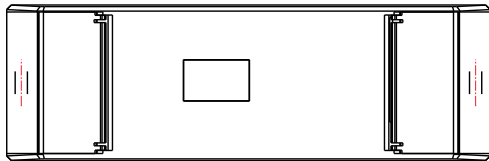

RGB-DMX-4C-RJ45 4 CHANNEL DMX DECODER

INPUT	12V - 24V DC
OUTPUT CURRENT	8A X 4CH
OUTPUT POWER	240W(12V), 720W (24V)
OUTPUT CHANNELS	3 or 4 selectable
DIMENSIONS	LxWxH (7"x 1.77"x 0.75")

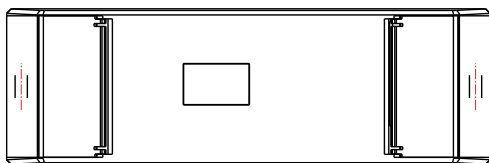

RGB-DMX-5C-XLR 5 CHANNEL DMX DECODER

INPUT	12V-24V-36V DC
OUTPUT VOLTAGE	12V-24V DC
OUTPUT CURRENT	8A X 5CH
OUTPUT WATTAGE	5 x (96W ~ 192W)
DIMENSIONS	LxWxH (6.45"x 2.87"x 1.5")

LSM55RGBW

5.0W Indoor Color-Changing + White LED Strip

COMPATIBLE NON-DIMMING TRANSFORMERS



PSHW SERIES NON-DIMMING CONSTANT VOLTAGE

PSHW-10W-24V	CLASS 2	2.55" X 1.37" X .90"
PSHW-20W-24V	CLASS 2	4.64" X 1.38" X 1.2"
PSHW-35W-24V	CLASS 2	5.83" X 1.57" X 1.18"
PSHW-60W-24V	CLASS 2	6.38" X 1.65" X 1.18"
PSHW-100W-24V		7.44" X 2.4" X 1.45"
PSHW-150W-24V		8.75" X 2.68" X 1.53"
PSHW-200W-24V		9.62" X 2.68" X 1.53"
PSHW-300W-24V		9.92" X 3.55" X 1.75"

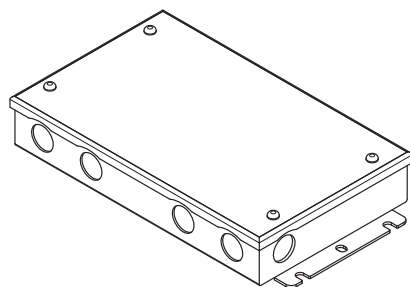

PSHK SERIES NON-DIMMING WITH JUNCTION BOX

PSHK-30W-24V-UNV	CLASS 2	6.5" X 3.6" X 1.02"
PSHK-60W-24V-UNV	CLASS 2	7.4" X 3.62" X 1.02"
PSHK-96W-24V-UNV	CLASS 2	8.66" X 3.66" X 1.61"
PSHK-150W-24V-UNV		10.24" X 4.06" X 1.81"
PSHK-200W-24V-UNV		10.24" X 4.06" X 1.81"
PSHK-300W-24V-UNV		10.94" X 4.25" X 1.81"