

SPECIFICATION SHEET

JOB NAME: _____
LOCATION: _____
QUOTE/REF#: _____

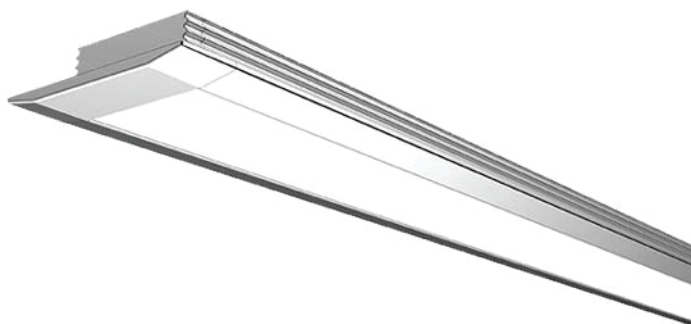

The **ALP-20R** is a recessed, Architectural Grade LED extrusion profile designed for linear LED strips up to **10mm (0.40in)** wide. Made from high quality anodized aluminum, these extrusions provide superior thermal management for higher wattage LED strips and prolong the lifespan of the lighting system. This surface mount profile comes with a patented frosted diffuser lens for maximum lumen output and wide beam distribution. The **ALP-20R** profile helps protect LED's from dust and other undesirable elements, which can shorten the LED's life. They are also an elegant design solution for any space.

FEATURES

- Customizable
- Durable, anodized aluminum
- Protects LED systems from dust and other elements
- Suitable for corner installations / applications.
- Dissipates heat from LED, prolonging its lifetime
- Suitable for recessed installations and applications

DIMENSIONS

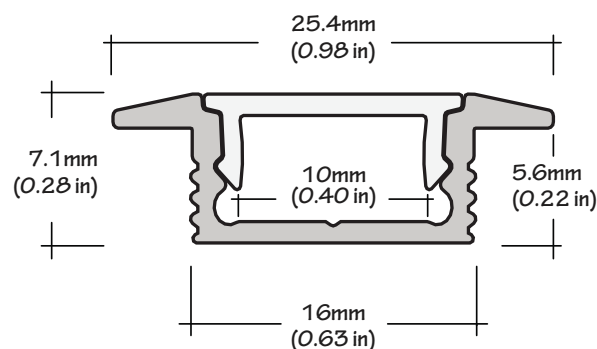

SPECIFICATIONS

TYPE	Recessed mount
AVAILABLE LENGTHS	49.25 in and 98.5 in
FINISH OPTIONS	White Black Silver
LENS OPTIONS	Frosted
CHANNEL	ALP-20R
LENS	ALP-20R-LN
END CAP	ALP-20R-EC

Compatible with LED strips up to **10mm (0.40in)** wide.

LED tape light sold separately.

Frosted Lens diffuser included (1 with every channel)

2 (two) end caps included with every channel.

Custom color finishes available (powder-coating).

ORDERING CODE

Model	Length	Lens	Light Engine	Finish
ALP-20R	49 - 49.25 in 98 - 98.5 in	FR - Frosted	See P. 3	WH White BK Black SI Silver CU Custom (powder-coat)



ALP-20R Recessed Mount LED Profile

ASSEMBLY

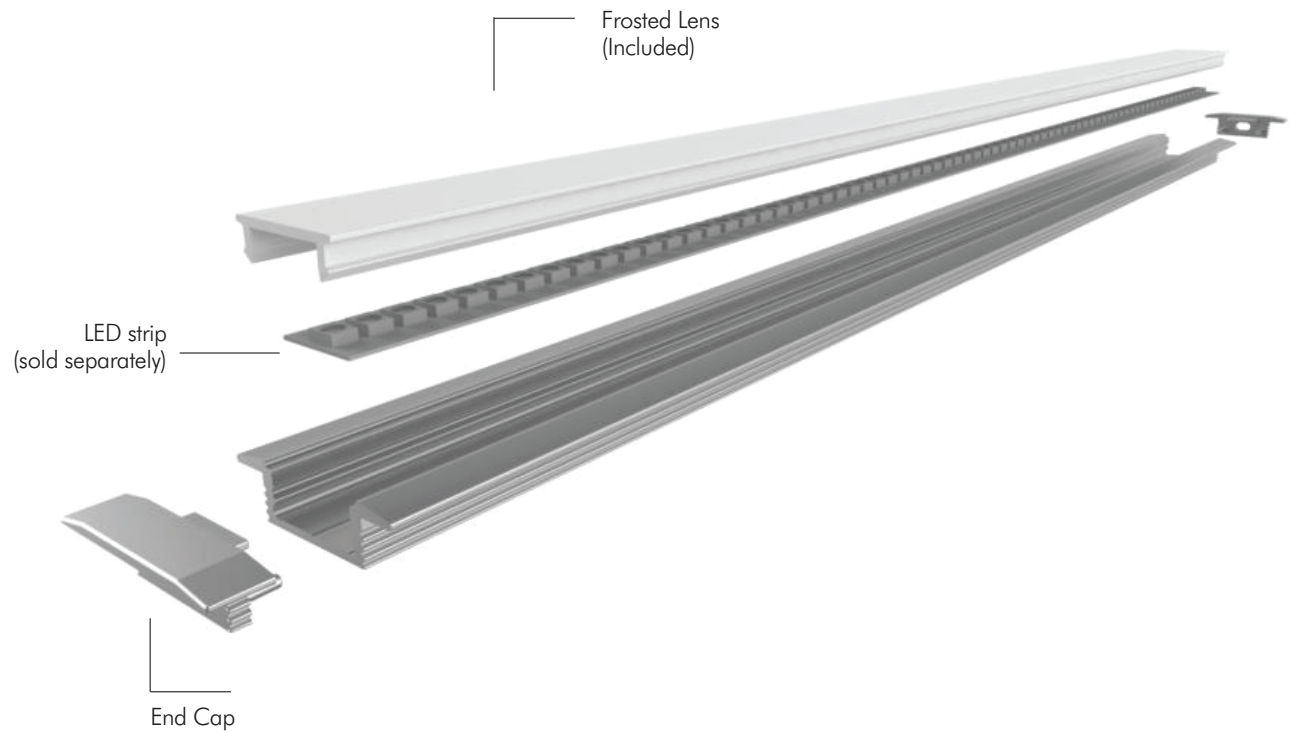

COMPATIBLE LED STRIPS

Indoor	Outdoor	Indoor Color-changing
LSM-15 1.5W/FT, 120 Lumens		LSP-20-RGB 2.2W/FT
LSM-25 2.2W/FT, 185 Lumens		LSP-50-RGB 4.4W/FT
LSM-30 3.0W/FT, 250 Lumens		LSP-50-RGB-DX 4.4W/FT Digital
LSM-35WD 3.6W/FT, Auto Warm Dim		
LSM-40HF 4.0W/FT, 440 Lumens		
LSM-45 4.4W/FT, 370 Lumens		
LSP-50 4.4W/FT, 380 Lumens		
LSM-55 5.5W/FT, 500+ Lumens		
LSM-55MX 5.5W/FT, 500+ Lumens		