

ALP2700TL

LED Wall Washer Profile

JOB NAME: _____
LOCATION: _____
QUOTE/REF#: _____

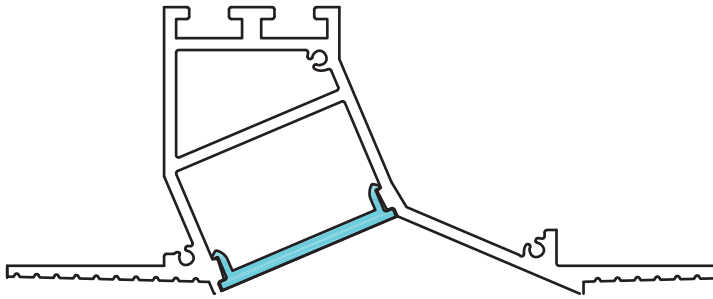

The ALP-2700TL is an Architectural Grade, LED extrusion profile designed for recessed applications. Made from high quality aluminum, these extrusions provide superior thermal management for higher wattage LED strips prolonging the overall lifespan of the lighting system. Manufactured with a patented frosted diffuser for maximum lumen output and a wider beam distribution.

SPECIFICATIONS

TYPE	Recessed mount
AVAILABLE LENGTHS	48" & 96"
FINISH	Matte White
LENS OPTIONS	Frosted
TRANSFORMER	Remote
APERTURE	1"
CHANNEL	ALP2700TL
LENS (INCLUDED)	ALP2100TL-LN

Compatible with LED strips up to 23.7mm (0.93") wide.

LED tape light sold separately.

Frosted Lens diffuser included w/ every channel

Custom color finishes available (powder-coating).

Remote mounted low-voltage power supply sold separately



FEATURES

- Customizable
- Field cuttable
- 1" Aperture
- Accommodates LED strips up to 23mm wide
- Recessed mount to fit flush onto installation surface
- Frosted Lens diffuser included
- Matte white powder coated finish
- Durable, anodized aluminum
- Protects LEDs from dust and other elements
- Dissipates heat from LED

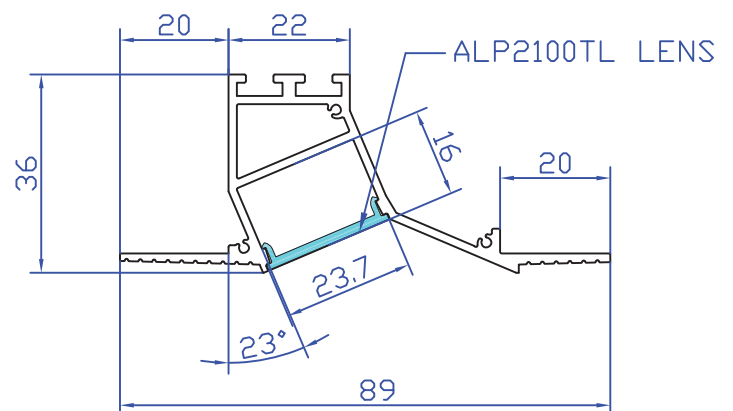

STANDARD ORDERING CODE (CHANNEL)

EX:
ALP2700TL-48-FR

Model	Length	Lens
ALP2700TL	48 48"	FR Frosted
	98 98"	

NOTE: Custom color finishes require powder coating. Allow 7 days lead time.

COMPATIBLE ACCESSORIES

ALP2700TL-EC | END CAP
(sold separately)

