

# ALP-65 Surface Mount LED Profile with Optic Options

**CORE**  
LIGHTING

## SPECIFICATION SHEET

JOB NAME: \_\_\_\_\_  
LOCATION: \_\_\_\_\_  
QUOTE/REF#: \_\_\_\_\_



The **ALP-65** is an Architectural Grade LED extrusion profile designed for linear LED strips **up to 10mm (.4")** wide. Made from high quality Aluminum, these extrusions provide superior thermal management for higher wattage LED strips and prolong the lifespan of your lighting system. This surface mount profile is manufactured with a patented frosted diffuser for maximum lumen output and wide beam distribution. The installed LED strip can be raised or lowered to adjust beam the beam angle. The **ALP-65** profile helps protect LED's from dust and other undesirable elements, which can shorten the LED's life. They are also an elegant design solution for any space.

### FEATURES

- Customizable
- Durable, anodized aluminum
- Protects LED systems from dust and other elements
- Suitable for corner installations / applications.
- Three optic options: **10°, 30° and 60°**
- Dissipates heat from LED, prolonging its lifetime

### DIMENSIONS

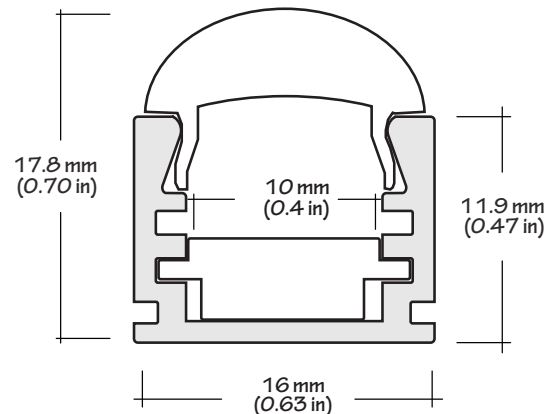

### SPECIFICATIONS

<b>TYPE</b>	Corner/Surface mount
<b>AVAILABLE LENGTHS</b>	49.25 in and 98.5in
<b>FINISH</b>	Anodized Aluminum
<b>LENS OPTIONS</b>	Frosted
<b>CHANNEL</b>	ALP-65
<b>LENS</b>	ALP-65-LN
<b>END CAP</b>	ALP-65-EC
<b>MOUNTING CLIPS</b>	ALP-65-CL

Compatible with LED strips up to **10mm (0.4in)** wide.

LED tape light sold separately.

Frosted Lens diffuser included (1 with every channel)

2 (two) end caps included with every channel.

Remote mounted low voltage power supply sold separately.

Power supplies available in 120V and 277V options.

Custom color finish available (powder-coating)

### ORDERING CODE

Model	Length	Lens	Optics	Light Engine	Finish
<b>ALP-65</b>	<b>48 - 48 in</b> <b>96 - 96 in</b>	<b>FR - Frosted</b>	<b>10 - 10°</b> <b>30 - 30°</b> <b>60 - 60°</b>	<b>See P. 3</b>	<b>SI</b> Silver
					<b>CU</b> Custom (powder-coat)

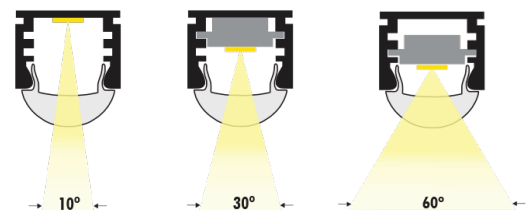

# ALP-65 Surface Mount LED Profile with Optic Options

## ASSEMBLY

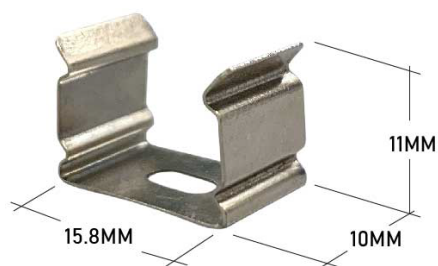
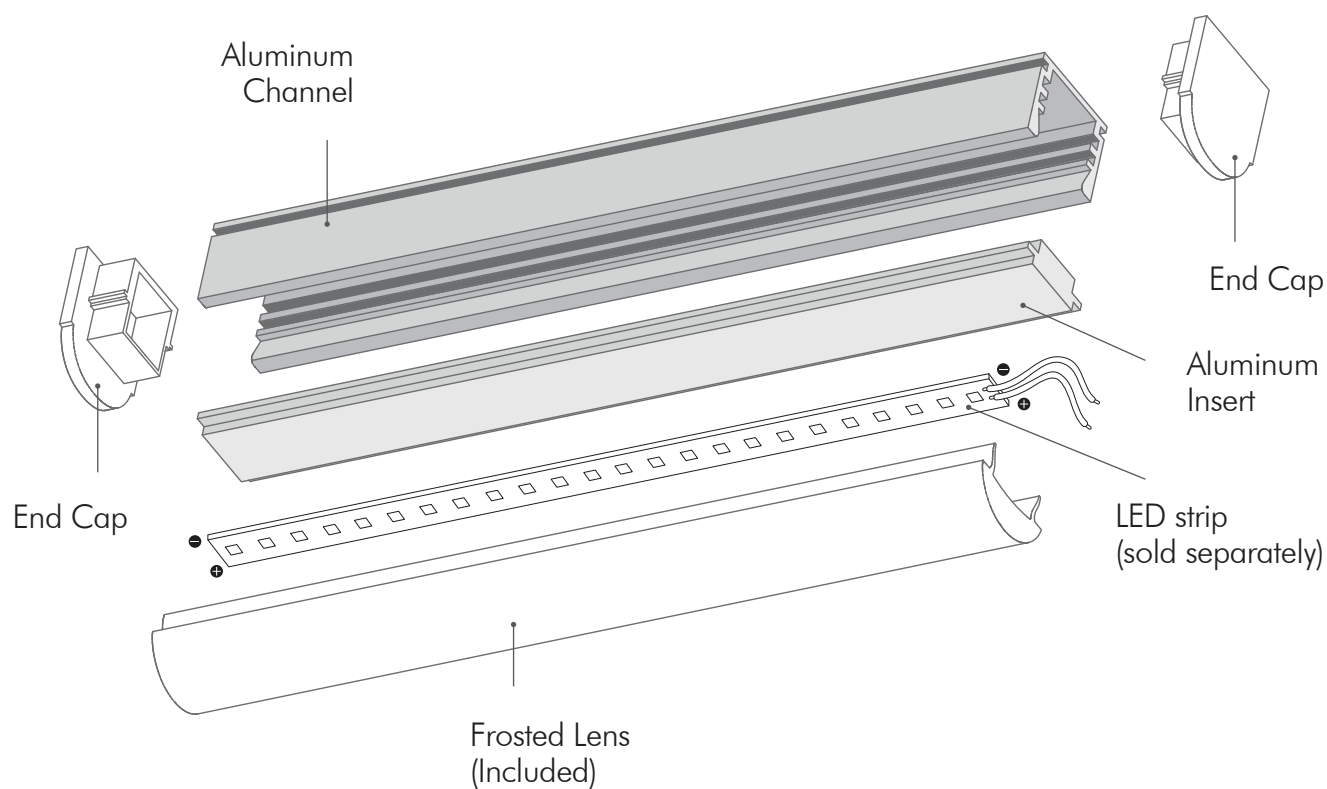

MOUNTING CLIP DIMENSIONS

# ALP-65

Surface Mount LED Profile with Optic Options



COMPATIBLE LED STRIPS

Indoor	Outdoor	Indoor Color-changing
<b>LSM-15</b> 1.5W/FT, 120 Lumens		
<b>LSM-25</b> 2.2W/FT, 185 Lumens		
<b>LSM-30</b> 3.0W/FT, 250 Lumens		
<b>LSM-45</b> 4.4W/FT, 370 Lumens		
<b>LSP-50</b> 4.4W/FT, 380 Lumens		
<b>LSM-55</b> 5.5W/FT, 500+ Lumens		