

POWER CORD INSTALLATION GUIDE

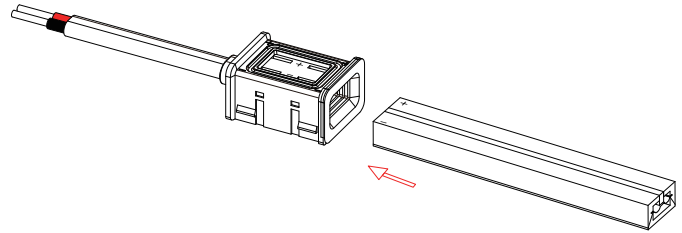

WARNING: RISK OF ELECTRICAL SHOCK
* turn off main power prior to installation
* make sure hands are dry
* never touch exposed wires

- 1 Keep connector holes and back side of LED strip facing up. Match positive (+) and negative (-) polarities on LED strip and Quick connector. Insert LED strip into connector as far deep as possible.



- 2 Press cap onto holes to have the copper of the connector connected to the LED tape's circuit. The connection is successful once you hear a click.

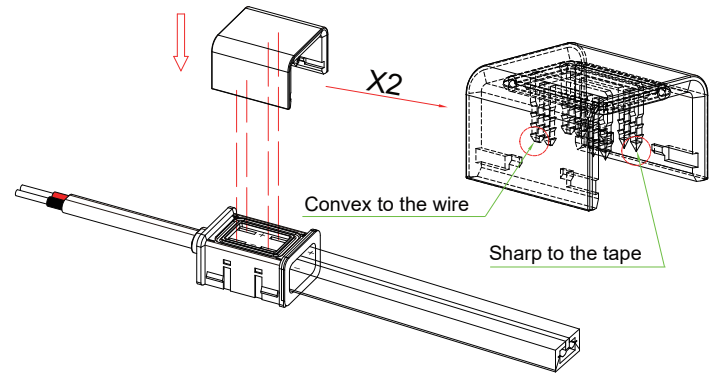

- 3 Connection complete.

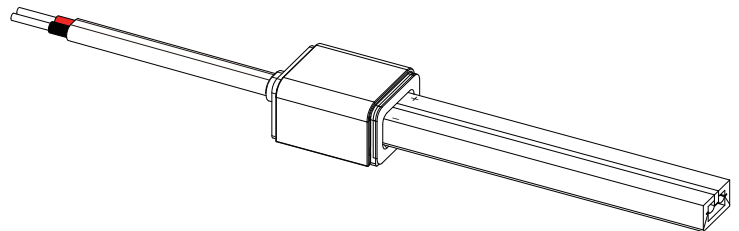

JUMPER INSTALLATION GUIDE



WARNING: RISK OF ELECTRICAL SHOCK
* turn off main power prior to installation
* make sure hands are dry
* never touch exposed wires

- 1 Keep connector holes and back side of LED strip facing up. Match positive (+) and negative (-) polarities on LED strip and Quick connector. Insert LED strip into connector as far deep as possible.

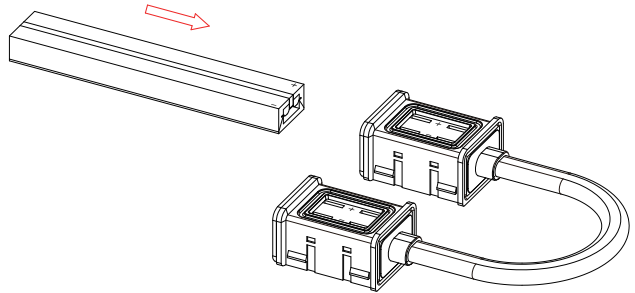

- 2 Press cap onto holes to have the copper of the connector connected to the LED tape's circuit. The connection is successful once you hear a click.

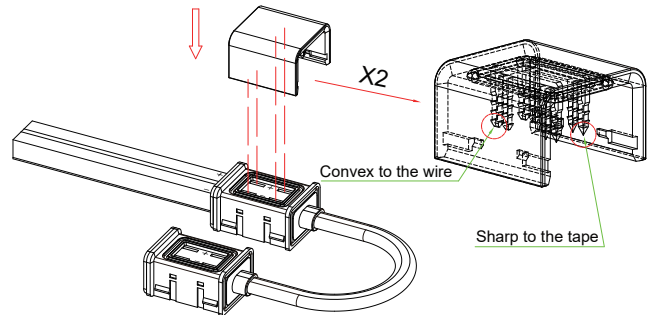

- 3 Repeat step 1 with the other LED strip.

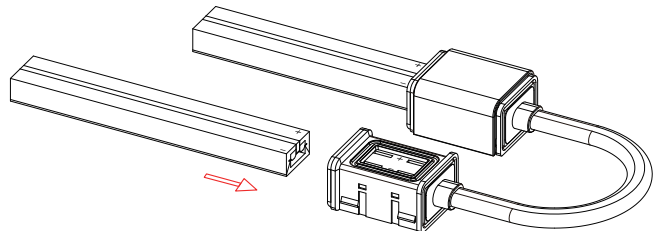

JUMPER INSTALLATION GUIDE



WARNING: RISK OF ELECTRICAL SHOCK
* turn off main power prior to installation
* make sure hands are dry
* never touch exposed wires

4 Repeat step 2 with the other LED strip.

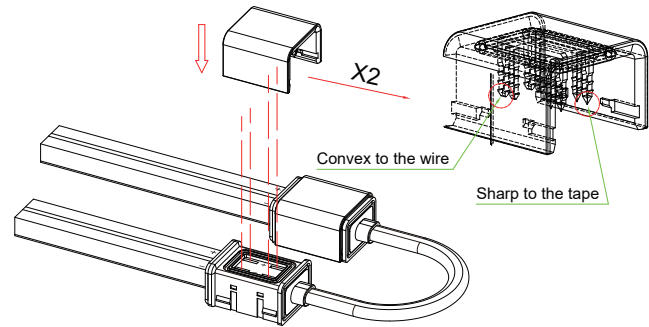

5 Connection complete.

