

ALP-50C

INSTALLATION INSTRUCTIONS

Job Name: Address: 

- 1 Make the electrical connection to the power supply and then run the wires to the location of the light fixtures.

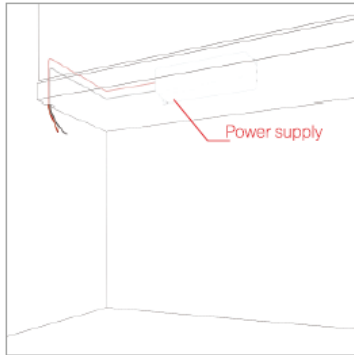
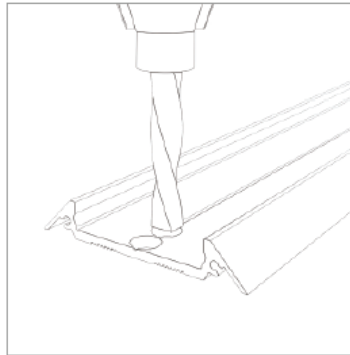

- 2 Drill a hole into the fixture for low voltage wires.

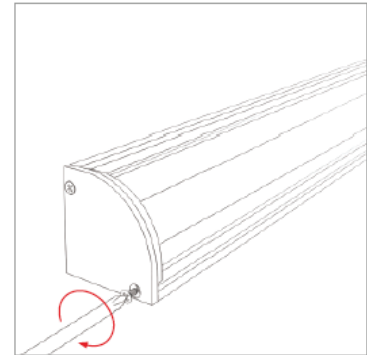

- 3 Secure the end caps.

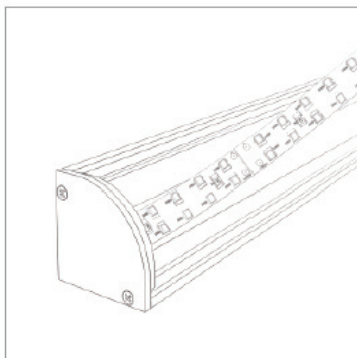

- 4 Install the DreamLED strip on the fixture surface.

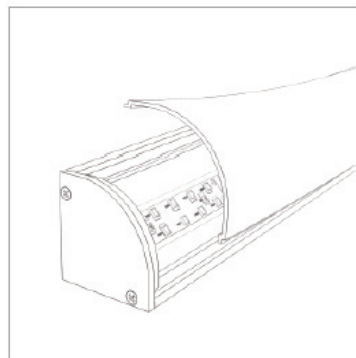

- 5 Install the diffuser.

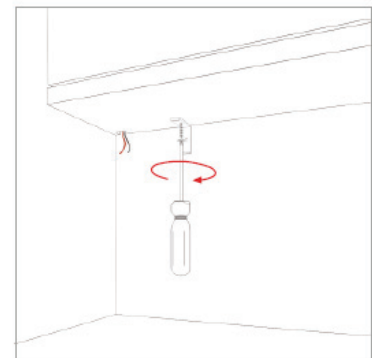

- 6 Install the mounting brackets.

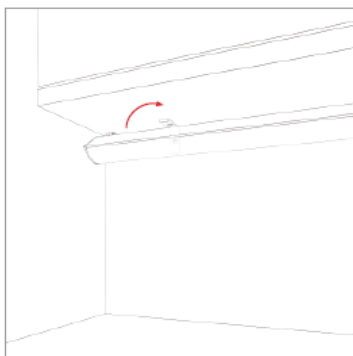

- 7 Connect the wires and install the fixture into the mounting brackets.

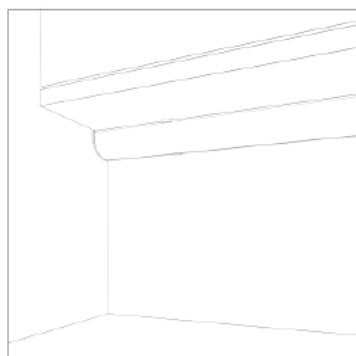

- 8 The fixture is ready for use. Enjoy the light!