

INSTALLATION / ASSEMBLY GUIDE

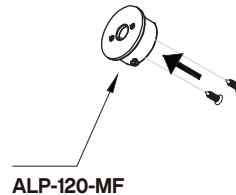

WARNING: RISK OF ELECTRICAL SHOCK
** turn off main power prior to installation*
** make sure hands are dry*
** never touch exposed wires*

- 1** INSTALL TWO (2) CLOSET ROD MOUNTING FLANGES (ALP-120-MF). SECURE TIGHTLY WITH A SCREWDRIVER.



- 2** INSTALL TWO (2) CLOSET ROD MOUNTING COVERS SUPPORT TO FIXTURE.

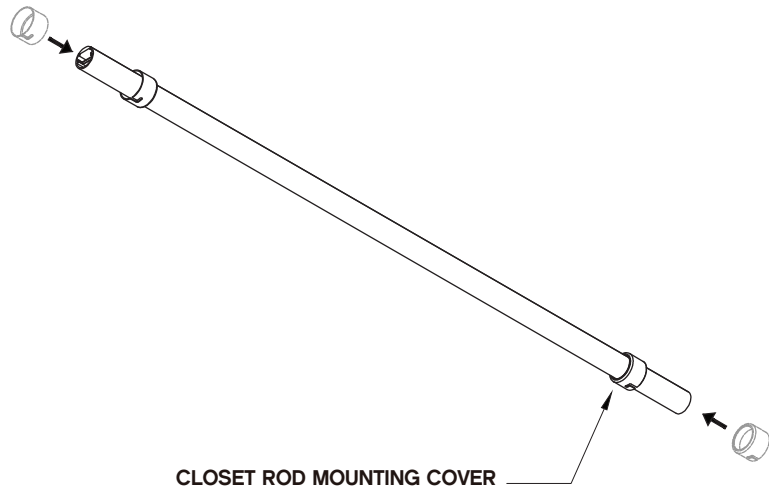

- 3** INSTALL ONTO CLOSET ROD MOUNTING BASE SUPPORT.

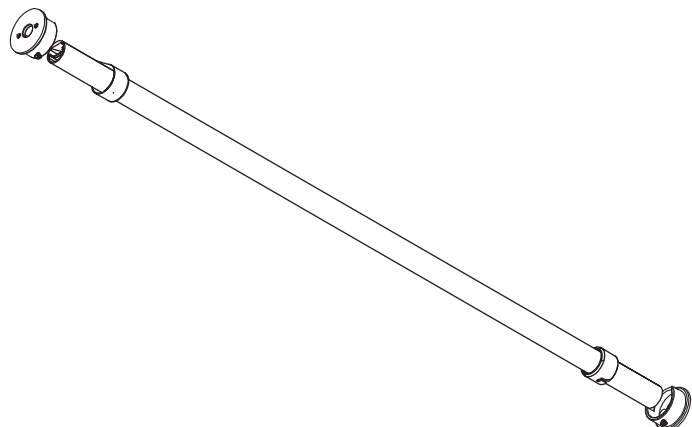

INSTALLATION / ASSEMBLY GUIDE



WARNING: RISK OF ELECTRICAL SHOCK
** turn off main power prior to installation*
** make sure hands are dry*
** never touch exposed wires*

- 4** MOVE MOUNTING COVERS INTO BASE TO HOLD THE FIXTURE. SECURE FIXTURE BY ROTATING THE COVERS UNTIL IT LOCKS INTO PLACE.

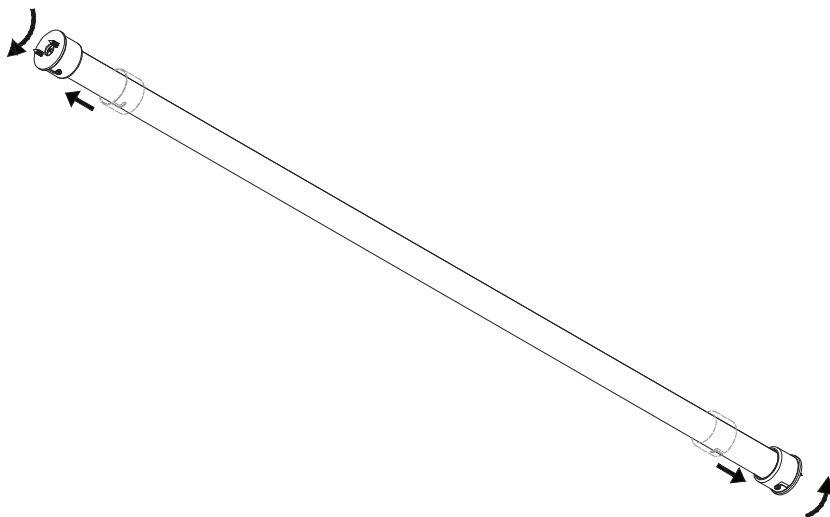

- 5** FIXTURES LONGER THAN 48" REQUIRE HANGING SUPPORT (ALP-120-HS)

